

Instruction Manual

Digital Scale

KW-210



The illustrations used in this manual are for illustration purposes and may differ from the actual product.

Table of contents

Safety Notes.....	2
Cautions	3
Name of Parts	4

Before Use

Preparation for Use	5
• Inserting/Replacing the Batteries	5
• Using the AC Adapter	5
• Auto power off time setting	6
• Location Code Setting	6
• Unit switching	6

How to Use

Operating Instruction	7
• Standard weighing	7
• Tare weighing	7

Cleaning	8
Troubleshooting	9
Product Specification	10

If Necessary



Please read this Instruction Manual carefully and keep it handy for future reference.

Safety Notes

In this Instruction Manual and description of the equipment, there are various caution symbols that will enable you to use this equipment safely and correctly so as to prevent harm to you and other people as well as loss or damage to your property.



Warning

This symbol indicates the risk of death or serious injury if the safety instructions are ignored or the equipment is misused.



Caution

This symbol indicates the risk of physical injury and/or damage to the equipment if the safety instructions are ignored or the equipment is misused.

Warning

- Never disassemble or modify the equipment. ▶ This may result in electric shock or bodily injury, or affect the accuracy of the product.

- When using the AC adapter, do not handle the plug with wet hands. ▶ This may cause an electric shock.

- Do not overload the electrical socket by connecting multiple extension cords, etc. ▶ Doing so may result in fire.

- Do not throw batteries onto a fire. ▶ Doing so may cause them to explode.

Caution

- When carrying the scale, hold the base firmly with both hands. ▶ Dropping the scale may cause damage or injury.

- Be sure to insert the batteries with the “+” and “-” symbols in the correct orientation. Do not use old and new batteries or use different types of batteries together. ▶ Doing so may result in the battery fluid leaking, heat generation or explosion of the batteries which may result in injury or damage to the scale.

- Do not insert your fingers into gaps etc. in the scale. ▶ Doing so may result in injury.

- Be careful not to drop this scale when handling with wet hands or when the scale is wet. ▶ Doing so may result in dropping the scale, resulting in damage to the scale or injury.

- When using the scale with the AC adapter, do not use in locations where the scale may be splashed with water. ▶ The waterproof performance of the scale may not be maintained, which may result in malfunction or electric shock.

Cautions

Cautions for Dust Proofing/Water Proofing

This scale is designed to meet IEC IP67 (dustproof/waterproof) standards, but when used in certain conditions the dustproof/waterproof functionality of the scale cannot be maintained. Additionally, such conditions may result in damage or malfunctions, and may prevent the scale from measuring accurately. Be sure to obey the following.

- Do not use when the battery cover or rubber cap (when the AC adapter is not being used) are removed.
- Do not allow water that is hotter than 40°C(104°F) or steam to come into contact with this scale.
- Do not wash this scale in a dishwasher.
- Do not leave this scale in water.
- Do not use this scale when it is wet.
- Do not touch the ventilation filter or the area around the filter.
- Do not allow substances such as oil (soot) or chemicals, or anything other than water to come into contact with the ventilation filter or the area around the filter.
- Do not touch the bellows unless cleaning the scale.
- Be careful not to damage the bellows when cleaning.
- Do not open and close the battery cover in locations where there is a lot of sand or dust, etc.

Instructions

Failure to obey these instructions may prevent the scale from measuring correctly, and may cause damage to the scale or result in malfunction.

- Use in a stable, flat location.
- After moving the scale to a location that has more than a 10°C(50°F) temperature difference from the previous location, leave for at least 2 hours before use.
- Use near lighting equipment (inverter fluorescent lamp), medical equipment (microwave therapy equipment), induction cookers, microwave ovens, communication devices (mobile phones, etc.) and other such devices may cause malfunction due to interference.
- When powdered substances, etc. are slowly added to the scale when zero is displayed, the display may not change. In such cases, place a slightly larger amount on the scale and then reduce to the required amount, or increase the speed at which the substance is placed on the scale.
- Do not place in a location that is exposed to direct sunlight, near a heater or directly in line with the air output from an air conditioner.
- Do not expose the scale to excessive shock or vibration.
- Do not use or store the scale in an extremely hot or cold location, or in a location that experiences extreme temperature differences.
- Do not use boiling water or chemicals such as benzene, thinner or bleach on the scale.

Name of Parts

Front of Unit

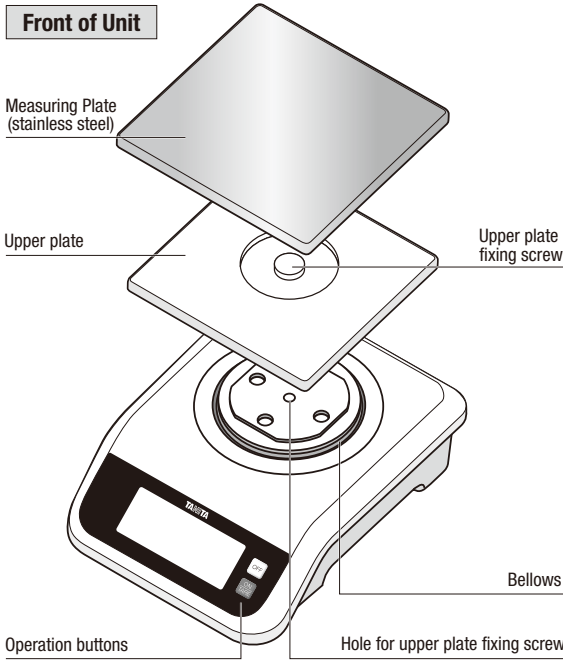

Accessories

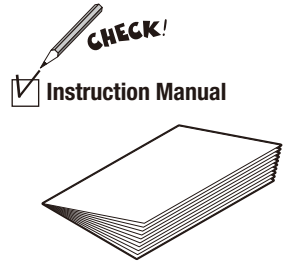

Back of Unit

Inside the Internal Pressure Adjustment Cover

First, remove the battery cover in order to open the internal pressure adjustment cover.

Rubber cap (for AC adapter)

Slide lock (catch for opening the battery cover)

Ventilation filter

Silicone feet (4)

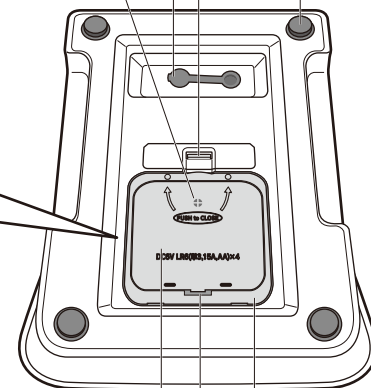
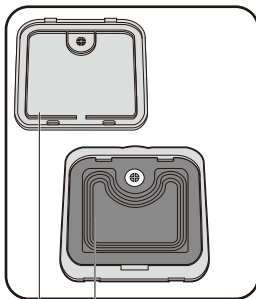

Battery box interior

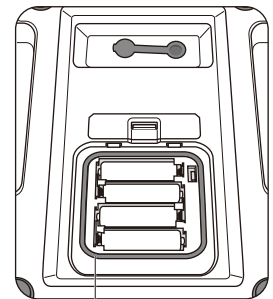

Preparation for Use

Inserting/Replacing the Batteries

⚠ Caution

- Before opening the battery cover, check that there is no water etc. around the battery cover.
- After closing the battery cover, be sure to check that all four corners are tightly closed.

When the batteries are depleted, “Lo” appears in the display and the power automatically turns off. Promptly replace the batteries with four new alkaline batteries within the recommended use limit.

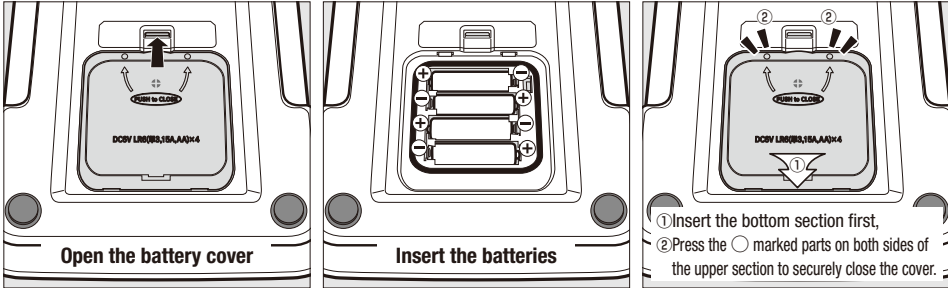

- Be sure to remove the measuring plate before turning the scale over, as failure to do so will result in the measuring plate falling off the scale.
- The provided batteries are fitted in the factory before shipment and may therefore have a short lifespan.
- Be sure to dispose of old batteries according to the disposal procedure prescribed in your area.



Important

Do not use new and old batteries or different types of batteries together.

Doing so may result in malfunction.

Using the AC Adapter

⚠ Caution

- When the AC adapter is used, the IEC IP67 standard (dustproof/waterproof) functions cannot be maintained.
- Do not use in locations where the scale may be splashed with water. Doing so may result in malfunctions or electric shock.

Remove the rubber cap and connect the AC adapter as shown in the figure on the right.

The AC adapter is an option. Purchase a 6V DC 200mA output centre minus plug compatible AC adapter separately. (Use an adapter that has an output current greater than 200mA.)

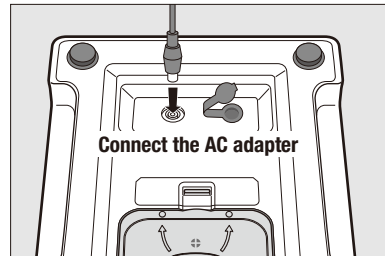
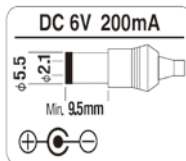

Preparation for Use

Auto Power Off Time Setting

Auto power off is a function to turn the power off automatically when no operation is executed after the set time has passed.

1 Press and release the **ON TARE** while holding down the **OFF** to show **SEt 1**.

Note: Press **ON TARE** to toggle between **SEt 1** and **SEt 2**.

2 When **SEt 1** is displayed, press **OFF** to display current time setting.
(Default is "10 minutes.")

3 Press **ON TARE** to select the set time you desire.

Time can be set to 10 minutes, 30 minutes or 60 minutes.

off 0 shows that auto power off is not implemented.

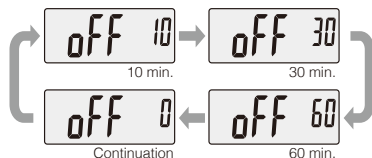

4 Press **OFF** to save the set time and setting ends.

•When **OFF** is not pressed, the set value will not be saved and the power will turn off 30 seconds later.

Location Code Setting (Refer to the Location Code Map)

Different locations across the world have different gravitational pulls. These differences affect the accuracy of the weight measurement. You can obtain the most accurate weight readings by selecting the correct gravity setting on the scale according to your geographical location.

1. When the power is off, press and release **ON TARE** while pressing **OFF**.
2. Press **ON TARE** once to select **SEt 2**, then press **OFF**.
3. Select your location code by repeatedly pressing the **ON TARE**. Refer to the Location Code Map.
4. Press **OFF** to save the setting, then the scale is automatically turned off.

Unit Switching

When the power is on, press and hold **ON TARE**, and then press **OFF** to switch the unit. (for the g/lb-oz version)

Operating Instruction

- Do not place anything on the measuring plate when turning the power on.
- Do not place any objects to be weighed directly on the upper plate. Always use the provided measuring plate.
-  appears in the display if the total weight of the container and contents exceeds 5000g/11lb (10000g/22lb) when the maximum weight is 10kg/22lb)

If the display value is less than -5000g/-11lb(-10000g/-22lb) when the maximum weight is 10kg/22lb),  appears in the display.

Standard weighing

1 Press .

After  flashes,  is displayed.

•When the measurement stabilizes the  mark is displayed.



2 Place an object on the tray to measure.



3 When  is pressed, the power turns off.



•When measuring continuously, remove the object to be measured from the tray, confirm that  is displayed, and measure again.

How to Use

Tare weighing

1 Conduct the operation of “normal measurement,” place the tare such as a tray or bag, and stabilise the display.



2 Press . The display becomes .



3 Place an object to be measured on the tare, and measure.



Cleaning

Parts other than the internal pressure adjustment rubber

1. Remove the measuring plate, loosen the upper plate fixing screw and remove the upper plate.
2. Clean the parts.
Wipe gently with a wet cloth. The parts can also be washed using a sponge or soft cloth soaked in neutral detergent.
 - Do not use water that is hotter than 40°C(104°F).
 - Be careful handling parts as wet parts will be slippery.
3. Use a dry cloth to thoroughly dry the parts.

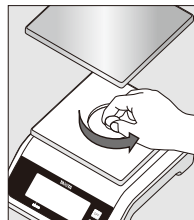

⚠ Caution

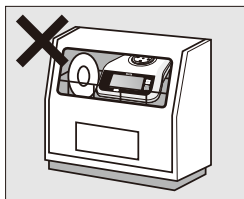

Do not wash in a dishwasher.

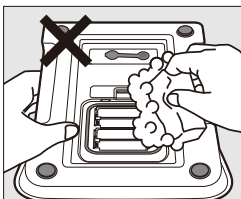

Do not wash if the battery cover is removed.



Do not touch the ventilation filter.

- Do not use chemicals such as benzene, thinner or bleach, etc.
- Be sure to check that the battery cover and rubber cap (for the AC adapter) are securely closed before cleaning the scale.

Internal pressure adjustment rubber

⚠ Caution

- Do not open the internal pressure adjustment cover other than for cleaning.

1. Remove the internal pressure adjustment cover that is attached to the battery cover using a coin.

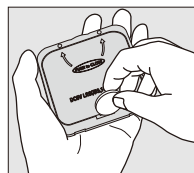

2. Use a cotton bud, etc. to wipe away dirt and moisture from the inside.
Be careful not to damage the internal pressure adjustment rubber.

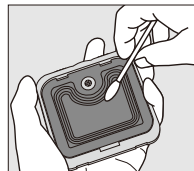



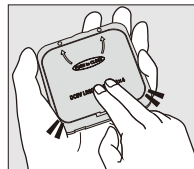



3. Press the internal pressure adjustment cover to close it.
Press firmly as it is designed to fit tightly.



4. Close the battery cover.

Troubleshooting

When you think that the equipment has trouble, check the following symptoms before asking for repair.

Symptom	Please check.	Page
<p>No display appears even  is pressed.</p>	<ul style="list-style-type: none"> • When using the equipment with an AC adapter Check connection between the DC jack and the AC adapter jack and between the plug and the outlet. • When using the equipment with batteries, batteries may be running low. Check after replacing with new batteries. 	5
<p> is displayed.</p>	<ul style="list-style-type: none"> • Batteries are running low. Replace with new ones immediately. 	5
<p> is displayed and the power turns off.</p>	<ul style="list-style-type: none"> • Precise measurement cannot be performed in a place with vibration. Move the equipment to a different place before use. 	3,7
<p> is displayed during measurement.</p>	<ul style="list-style-type: none"> • Weighing capacity is exceeded. 	7
<p> or  is displayed.</p>	<ul style="list-style-type: none"> • The scale needs to be repaired. Please contact your retailer. 	

Product Specification

Type	KW-210	
Maximum measurement /Minimum display	5kg/1g (11lb/0.05oz)	10kg/2g (22lb/0.1oz)
Waterproof Protection Class	IP67*1 (When run on batteries)	
Power consumption	Average 0.02W	
Power supply	DC6V LR6(15A,AA) ×4 pieces (not included) AC adapter - DC6V 200mA centre minus*2	
Battery life	Approximately 300 hours	
Body size/Upper plate size	D263×W200×H114mm(D10.4×W7.9×H4.5in) /D182×W182mm (D7.2×W7.2)	
Product mass	Approximately 2.2kg (4.8lb)	

*1IP67 is the IEC (International Electrotechnical Commission) 60529 standard defined as the “complete prevention against the ingress of fine particles” and “no ingress of water in a quantity that can affect the device functions after submersion at a depth of 1m for 30 minutes”.

*2AC adapter is an option. (See P5).

•The product design and specifications may be changed at any time without prior notice.

Federal Communications Commission and Canadian ICES Notice

This equipment has been tested and found to comply with the limits for a Class B digital device, pursuant to Part 15 of the FCC Rules and Canadian ICES-003. These limits are designed to provide reasonable protection against harmful interference in a residential installation. This equipment generates, uses and can radiate radio frequency energy and, if not installed and used in accordance with the instructions, may cause harmful interference to radio communications. However, there is no guarantee that interference will not occur in a particular installation. If this equipment does cause harmful interference to radio or television reception, which can be determined by turning the equipment off and on, the user is encouraged to try to correct the interference by one or more of the following measures:

- **Reorient or relocate the receiving antenna.**
- **Increase the separation between the equipment and receiver.**
- **Connect the equipment into an outlet on a circuit different from that to which the receiver is connected.**
- **Consult the dealer or an experienced radio or television technician for help.**

Modifications

The FCC requires the user to be notified that any changes or modifications made to this device that are not expressly approved by Tanita Corporation may void the user's authority to operate the equipment.



Notice:

These marks can be found out on contaminant-containing

Batteries: **Pb Pb** = Battery contains lead,
Cd Cd = Battery contains cadmium,
Hg Hg = Battery contains mercury.

Not allowed to mix batteries with consumer wastes!

As consumer you are legally bound to return used or discharged batteries. You can deposit your old batteries at the public collecting points in your town, or wherever the corresponding batteries are sold and specifically marked collecting boxes have been set up. In case of scrapping the apparatus, the batteries should be removed from it and deposited at the collecting points as well.



This device meets the EMC Directive 2004/108/EC and the RoHS Directive 2011/65/EU.

Representative

TANITA Europe B.V.

Hoogoorddreef 56-E
1101 BE Amsterdam
The Netherlands
Tel: +31-20-560-2970
Fax: +31-20-560-2988
www.tanita.eu

TANITA Corporation of America Inc.

2625 South Clearbrook Drive
Arlington Heights, IL 60005 USA.
Tel: +1-847-640-9241
Fax: +1-847-640-9261
www.tanita.com

TANITA India Private Limited

A-502, Mittal Commercial,
Off. M. V. Road (Andheri Kurla Road),
Marol, Andheri - East,
Mumbai, India 400 059
Tel: +91-22-3192-6107
Fax: +91-22-2859-9143
www.tanita.co.in

TANITA Health Equipment H.K. Ltd.

Unit 301-303 3/F Wing On Plaza,
62 Mody Road, Tsimshatsui East,
Kowloon, Hong Kong
Tel: +852-2834-3917
Fax: +852-2838-8667
www.tanita.asia

TANITA (Shanghai) Trading Co. Ltd.

Room 8005, 887 Huai Hai Zhong Lu, Shanghai
The People's Republic of China
Tel: +86-21-6474-6803
Fax: +86-21-6474-7901
www.tanita.com.cn

Manufacturer

TANITA Corporation

1-14-2, Maeno-Cho, Itabashi-ku,
Tokyo, Japan 174-8630
Tel: +81(0)-3-3968-7048
Fax: +81(0)-3-3968-2661
www.tanita.co.jp
ISO 9001 Certified