

BODY COMPOSITION ANALYZER

MC-780U

Instruction Manual

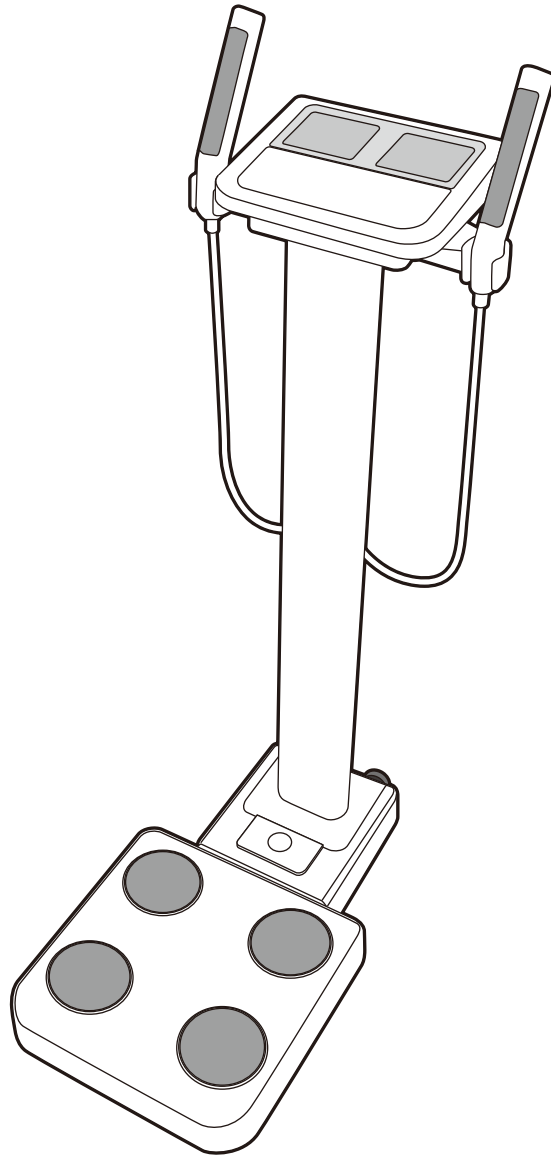

<Usage Conditions>

Temperature : 32°F – 95°F (5°C – 35°C)
Relative Humidity : 30% – 80%
(without condensation)
Maximum Altitude : 6,500ft ASL (2,000m ASL)
Pressure : 86kPa – 106kPa

<Storage Conditions>

Temperature : 14°F – 140°F (-10°C – 50°C)
Relative Humidity : 10% – 90% (without condensation)
To avoid malfunctions, avoid storing the equipment in a place with direct sunlight, significant temperature changes, a risk of dampness, a large amount of dust or a risk of vibration or impact, or in the vicinity of flames.



Please read this Instruction Manual carefully and keep it for future reference.

Intended Use

Tanita Body Composition Analyzers have been clinically proven to be accurate, reliable and provide highly repeatable results. Our Analyzers are used worldwide by health, research and medical professionals primarily in the following fields:

- medical screening and health assessments of adults and children
- monitoring the progress of weight loss during medical treatment relating to lifestyle diseases such as diabetes, hyperlipidemia, bariatric surgery, hypertension and fatty liver disease.
- monitoring increases of muscle mass, reduction of body fat and hydration levels as part of a fitness or training program
- assessing the true effectiveness of nutrition and physical activity programs where body mass index cannot identify key changes in body composition
- collating subject data for large cohort research studies

The Tanita Body Composition Analyzer is indicated for use in the measurement of weight and impedance, and the estimation of body mass index (BMI), total body and segmental fat percent and weight, total body water percent and weight, intracellular and extracellular water weight, total body and segmental muscle mass, physique rating, bone mass, visceral fat rating with healthy range, basal metabolic rate (BMR), and fat free mass (FFM), using BIA (Bioelectrical Impedance Analysis).

The device is indicated for use for healthy children 5-17years old and healthy adults with active, moderately active, to inactive lifestyles. For subjects 17years old and younger, only fat % is displayed.

Efficacy

This product has been specifically designed to be simple to use and required no additional user assistance to take a measurement.

Measurements can be taken in under 30 seconds for maximum convenience.

Contents



Before Use

For Your Safety	4
Part Names & Connection	8
Preparation	10
Power Supply	14
Settings	15

How to Use

Taking a Measurement	17
Body Composition Mode	17
Measurement Results	19
Scale Mode	21
Weight Lock Mode	22
Various criteria	23
What is body fat percentage?	23
What is total body water percentage?	24
What is visceral fat rating?	24
What is basal metabolic rate (BMR)?	25
What is muscle mass?	26
What is bone mass?	27
Output and Storage of Measurement Results	28

If Necessary

Troubleshooting	30
Technical notes	31
The Regression Formula for Basal Metabolic Rate (BMR)	35
Specifications	37

For Your Safety

GB

Before Use
(cautions for safety)

This section explains precautionary measures to be taken to avoid injury to the users of this device and others, and to prevent damage to property. Please familiarise yourself with this information to ensure safe operation of this equipment.

 **Warning** Failure to follow instructions highlighted with this mark could result in death or severe injury.

 **Caution** Failure to follow instructions highlighted with this mark could result in injury or damage to property.



This mark indicates actions that are prohibited.



This mark indicates instructions that must always be followed.

Warning



Prohibited

This equipment must not be used on subjects with pacemakers or other mechanical implants.

This equipment passes a weak electrical current through the body which could interfere with and cause the malfunction of electrical medical implants, resulting in serious harm.



Do not handle the plug with wet hands.

This may result in electric shock, fire, or leakage.



Keep this equipment away from flammable gas and oxygen-rich environments.

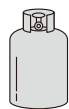

Do not modify this equipment in any way.

This can cause electric shock or injury, or affect the accuracy of analysis.

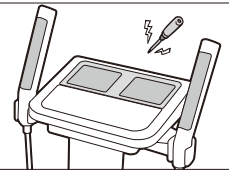

Do not use a multi-plug adapter.

This may cause fire.

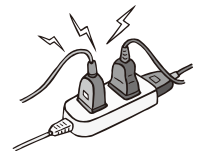

Caution



Prohibited

Keep away from water.

Avoid using on subjects with metal allergies.

Allergic reactions may be caused by the stainless steel used in the electrodes of this device.

Do not jump on the equipment.

Do not lean on the equipment.

Do not use this equipment near other products that emit electromagnetic waves.

Do not insert fingers into gaps or holes.

Do not apply force to the display.

The screen panel may break and cause injury.

Do not place items sensitive to magnetic forces near the equipment.

The magnet of the impedance meter may cause corruption of data on devices such as USB memory sticks if these are placed near the equipment.

Assist persons with disabilities.

Another person should assist persons with disabilities who may not be able to take a measurement alone.



Always...

Clean the scale platform with appropriate disinfectant after each use.

Stand clear of the subject during measurement to ensure accuracy.

Continually monitor both the subject and the equipment for anomalies.

If an anomaly in the subject or equipment is discovered, take appropriate action, such as stopping the equipment, while ensuring the safety of the subject.

Use the included AC adapter.

Do not lean against the equipment.

Unplug the AC cable from the equipment when moving it.

Tighten the adjustable feet when moving the equipment.

Interpretation of analysis results (e.g. evaluation of measurements and formulation of exercise programmes based on results) must be performed by a professional.

Weight loss measures and exercise based on self-analysis could be harmful to you health. Always follow the advice of a qualified professional.

This equipment is designated a Class B IT device (mainly for systems intended to be used in internal environments) and is CE (EMC) certified, but it may affect devices that are sensitive to electromagnetic waves.

If connecting a computer or peripheral devices to this equipment, please use devices complying with IEC60601-1 (EN60601-1). Power must be supplied from a medical isolation transformer for IEC60950(EN60950) devices. Keep a distance of 4.9ft (1.5m) between units during operation. Failure to do so may cause electric shock to subjects or malfunction.

For Accurate Measurements

Avoid measuring after strenuous exercise.

This may cause inaccurate measurements. Please take measurements after sufficient rest.



Avoid measuring after excessive food or fluid intake or when dehydrated.

This may cause inaccurate measurements. For greater accuracy, avoid using directly after waking up. Use at the same time on each occasion, at least three hours after a meal.



Ensure arms are not touching sides and inner thighs are not touching each other during measurement. If necessary, place a dry towel between arm and side and/or between thighs.

Do not take measurements while using transmitting devices, such as mobile phones, which may affect readings.

Use the equipment under the same conditions and in the same position as much as possible for accurate tracking of changes.

Readings are affected by the level of hydration and position of the body. Please use at the same time of day each time, under the same conditions and in the same body position.



Avoid measuring in multiple locations with greatly differing temperatures.

This may cause inaccurate measurements. Allow the equipment to stand for at least 2 hours before using if it is moved to a new location with a temperature difference of 68°F(20°C) or more.



Make sure the soles of feet are free of excess dirt, as this may block the mild electric current.

Always hold both arms straight down when taking measurements to prevent measurement errors such as undermeasurement of body fat.

Bare feet should be placed correctly on the electrode platform. Place arms straight down during measurement.

Use in a stable location.

Errors in measurements may occur if the device is used in an unstable location.

Scheduled Maintenance

TANITA recommends that each facility conduct periodic checks of each unit.

1. Check the following at least daily:
 - The unit is on a stable and level surface ie on a firm flooring, not on a thick carpet
 - Date and time settings
2. Visually inspect the following at least weekly:
 - The display for any damage or contamination
 - All cables, cords, and connector ends for damage or contamination
 - All safety-related labeling for legibility
 - All accessories (sensors, electrodes, etc.) for wear or damage
3. Visually inspect the following at least monthly:
 - Mounting screws on stand

Update settings, replace items, or call for service as necessary according to the results of the visual inspections. Do not use the unit if you see any signs of damage. Equipment that has been damaged must be checked for proper operation by qualified personnel before using again.

Part names & Connection procedure

GB

Before Use
(cautions for safety)

Symbols and their Meanings

	Positive polarity		Serial interface
	Alternating current		Direct current
	Input, Output		Type BF applied part - Grips and platform
	Caution Refer to the attached notes.		WEEE - Waste Electrical and Electronic Equipment Directives
	SD card		For indoor use only
			See the instructions

*The SD logo is a registered trademark of the SD Association.

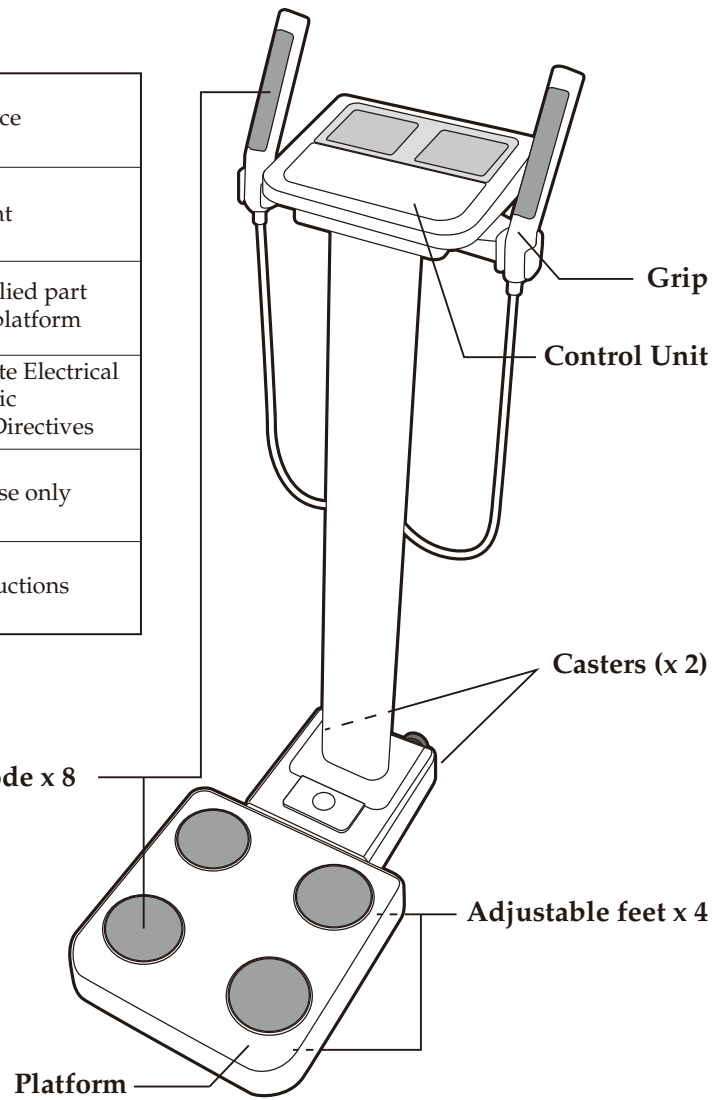

Control unit Connection of Plugs

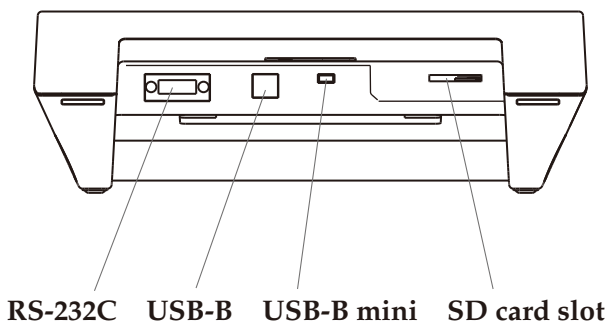

Platform Connection of Plugs

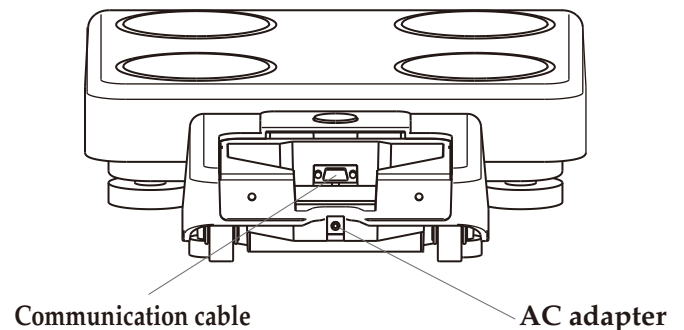

Display and Keys

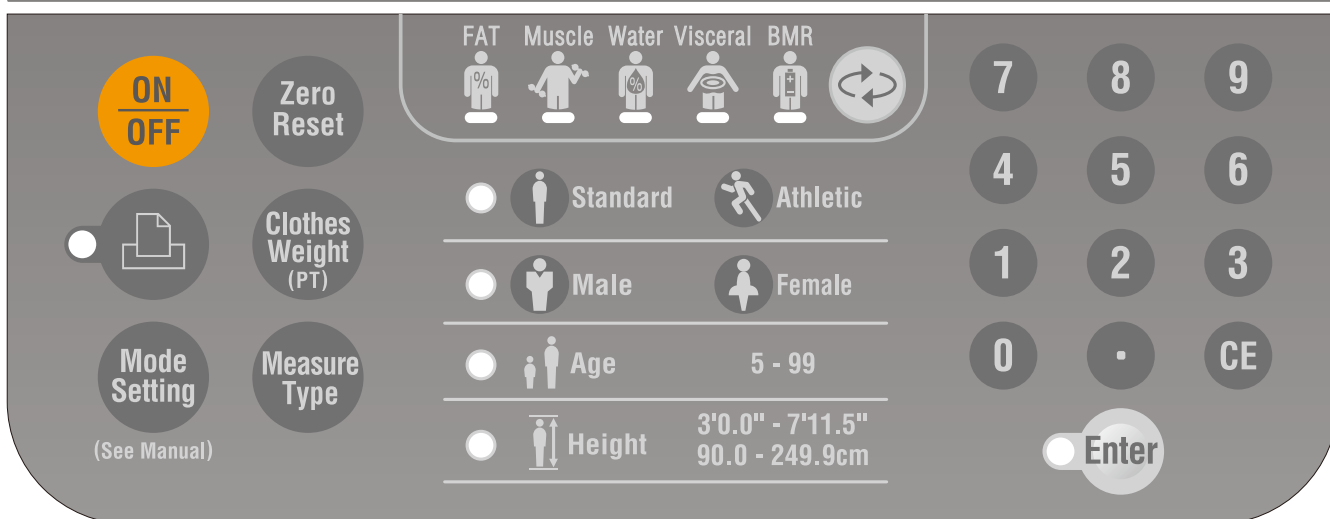
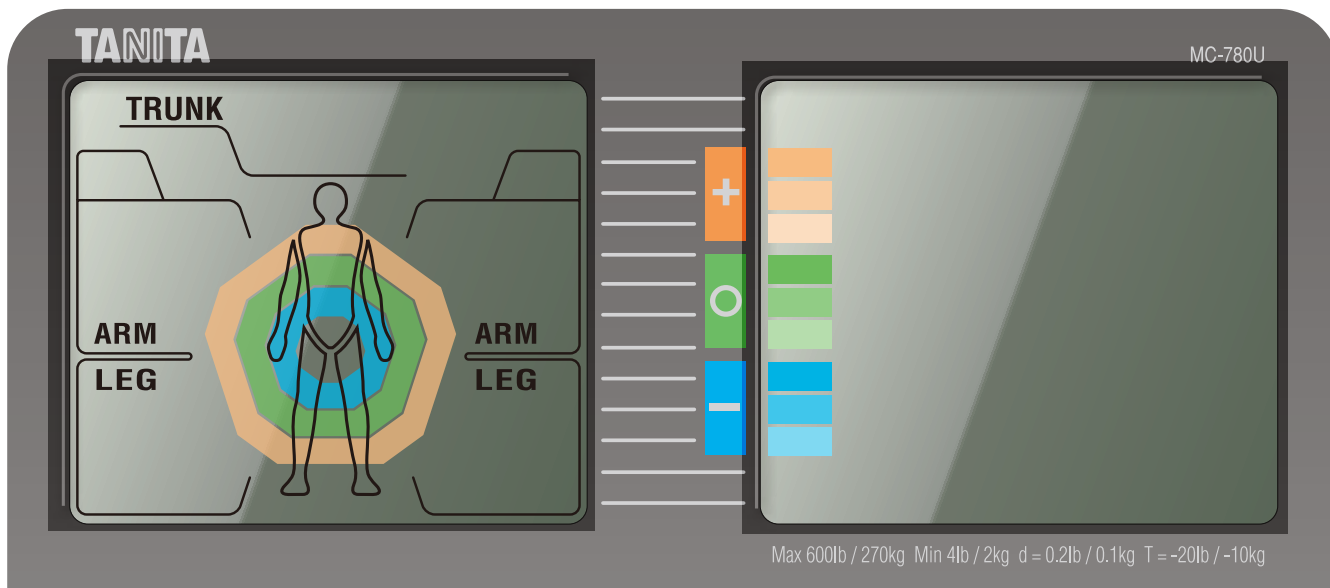

Meanings of the LED Indicators and Keys

	Turn ON / OFF the power
	Printout result
	Set various functions
	Reset zero point
	Set preset value (Clothes weight)
	Select measurement mode

	Display Body Fat (percentage and mass) *Not measured value but calculated value		
	Display Body Muscle (percentage and mass) *Not measured value but calculated value		
	Display Body Water (percentage and mass) *Not measured value but calculated value		
	Display Visceral Fat Rating		Display Basal Metabolic Rate
		Indicates whether "Standard mode or Athletic mode" is selected as the body type.	
		Indicates whether "Male or Female" is selected as the gender	
	5 - 99	Enter the age between "5 - 99 years"	
	3'0.0" - 7'11.5" 90.0 - 249.9cm	Enter the height between "3'0.0"-7'11.5"/90.0cm -249.9cm"	
	Confirms the entered numerical value.		

Preparation

Setting up the main unit

GB

Before Use
(cautions for safety)

Platform / Control Box / Accessories

- CD-ROM (This manual)
- Assembly guide

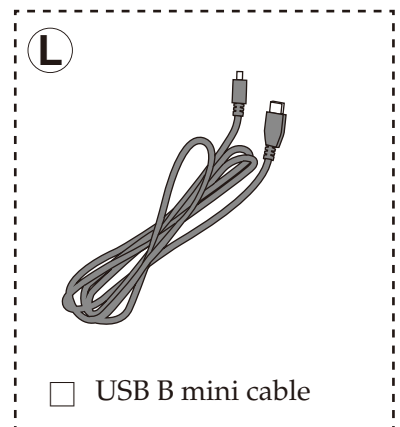
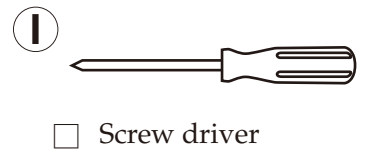
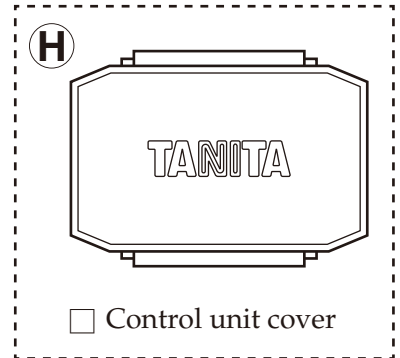
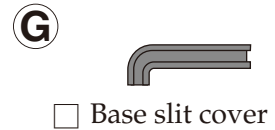
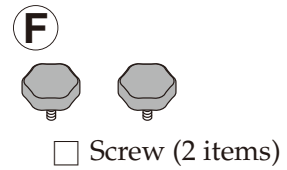
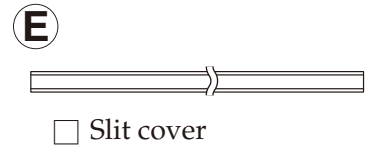
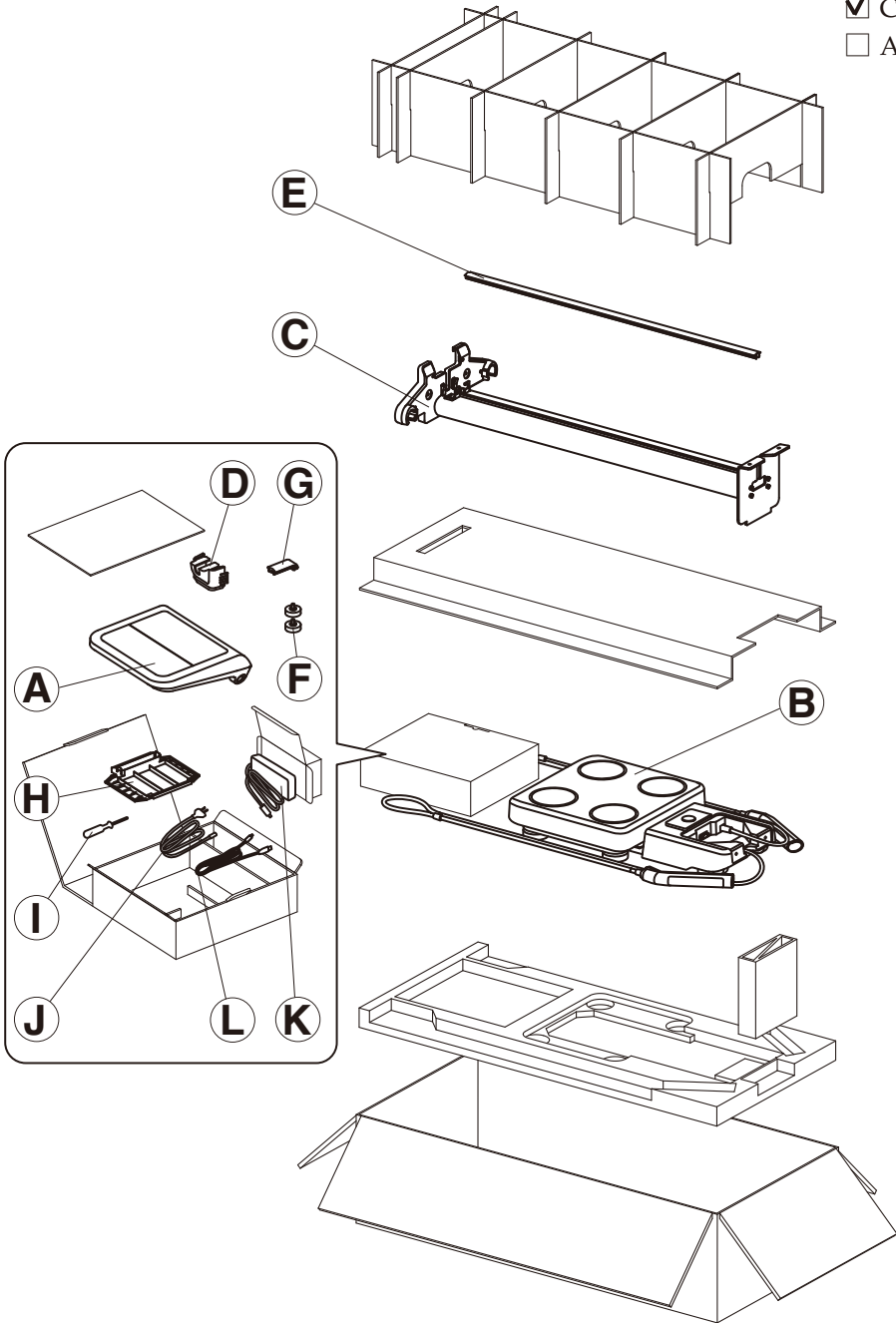

Assembly

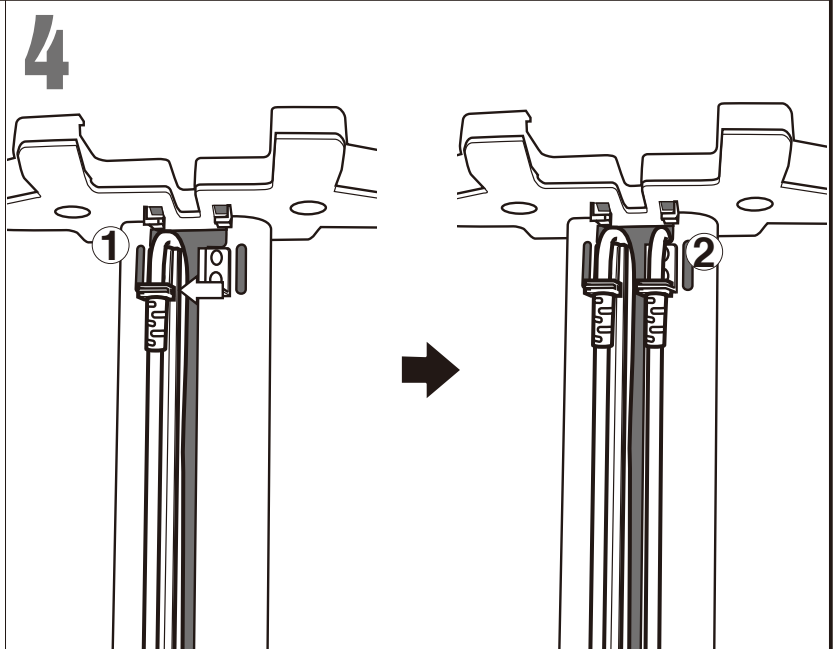
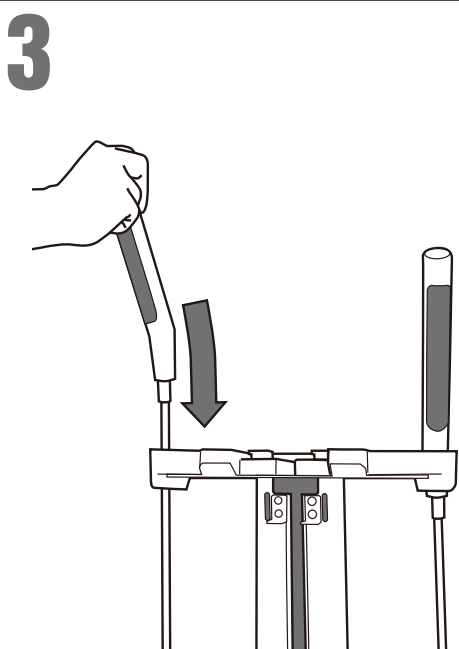
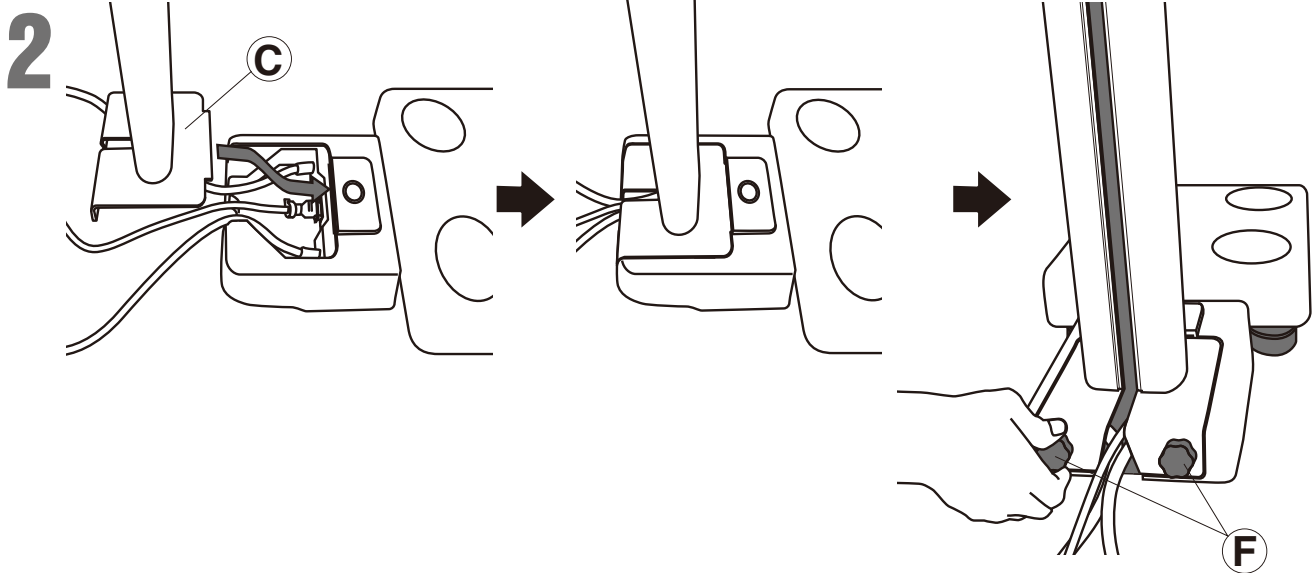
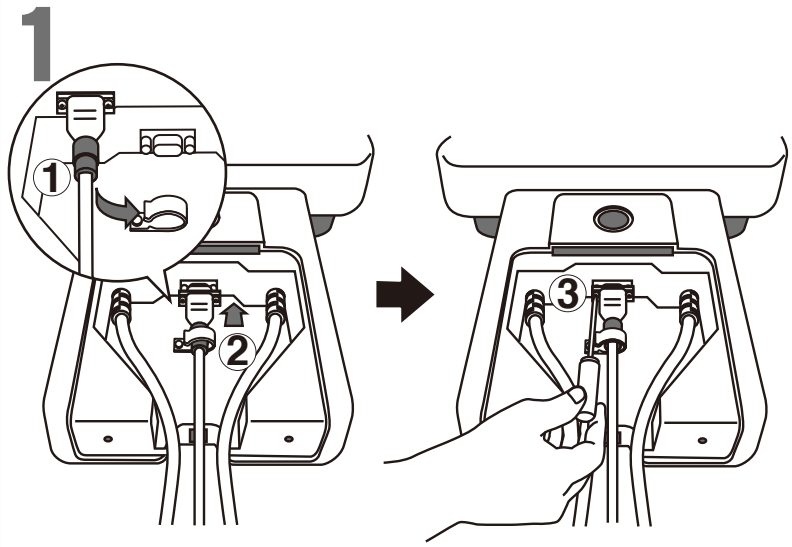
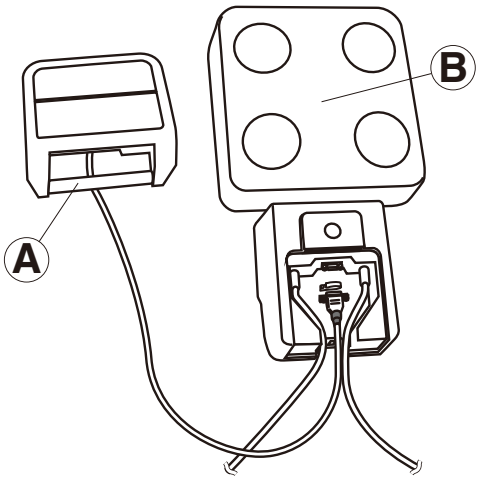

Preparation

Setting up the mainunit

GB

Before Use
(cautions for safety)

Assembly (continued)

5

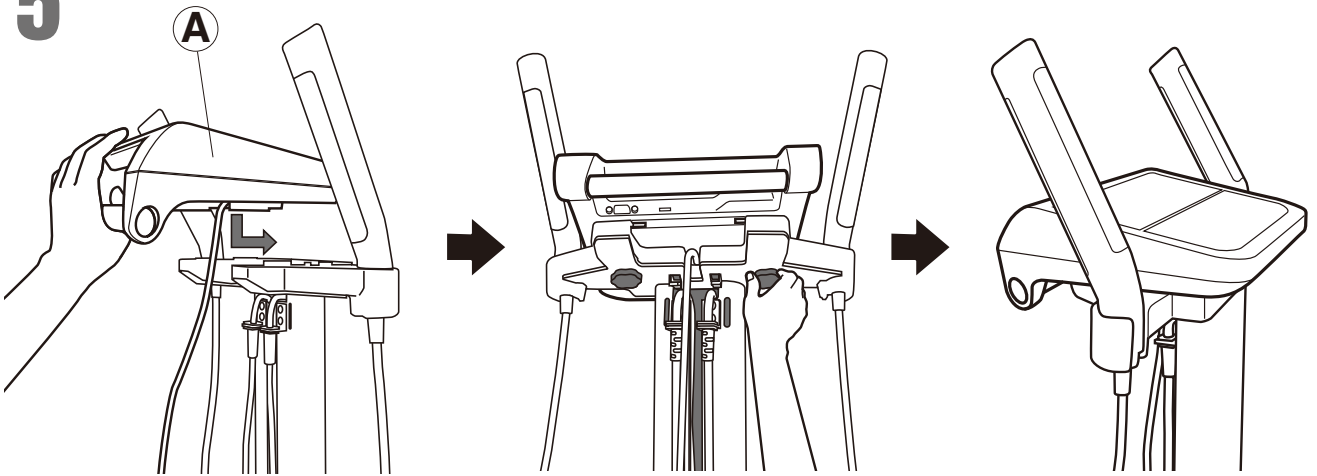

6

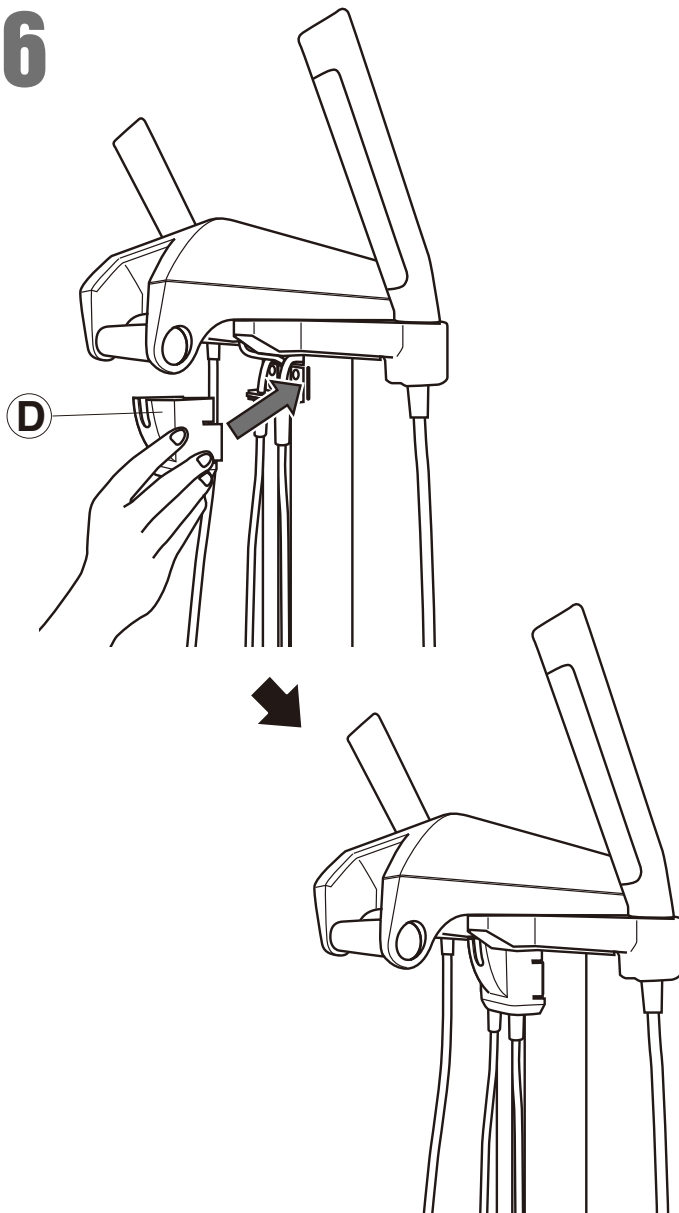

7

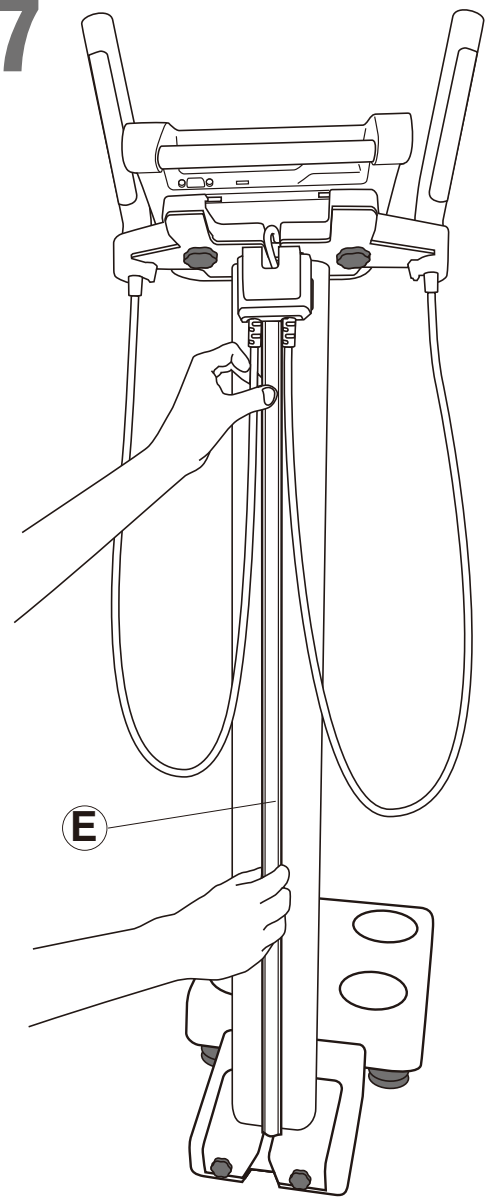

Assembly (continued)

8

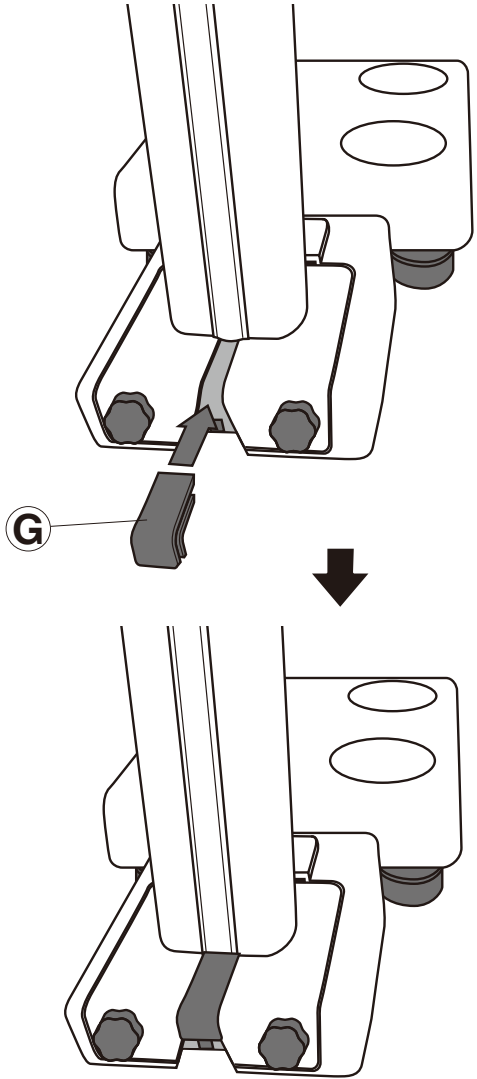

9

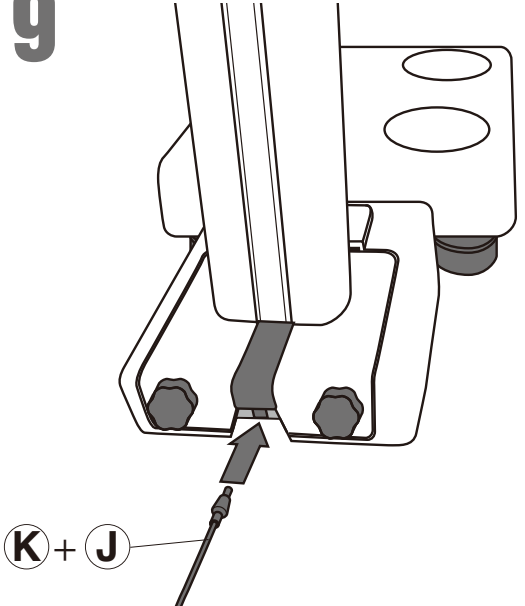

10

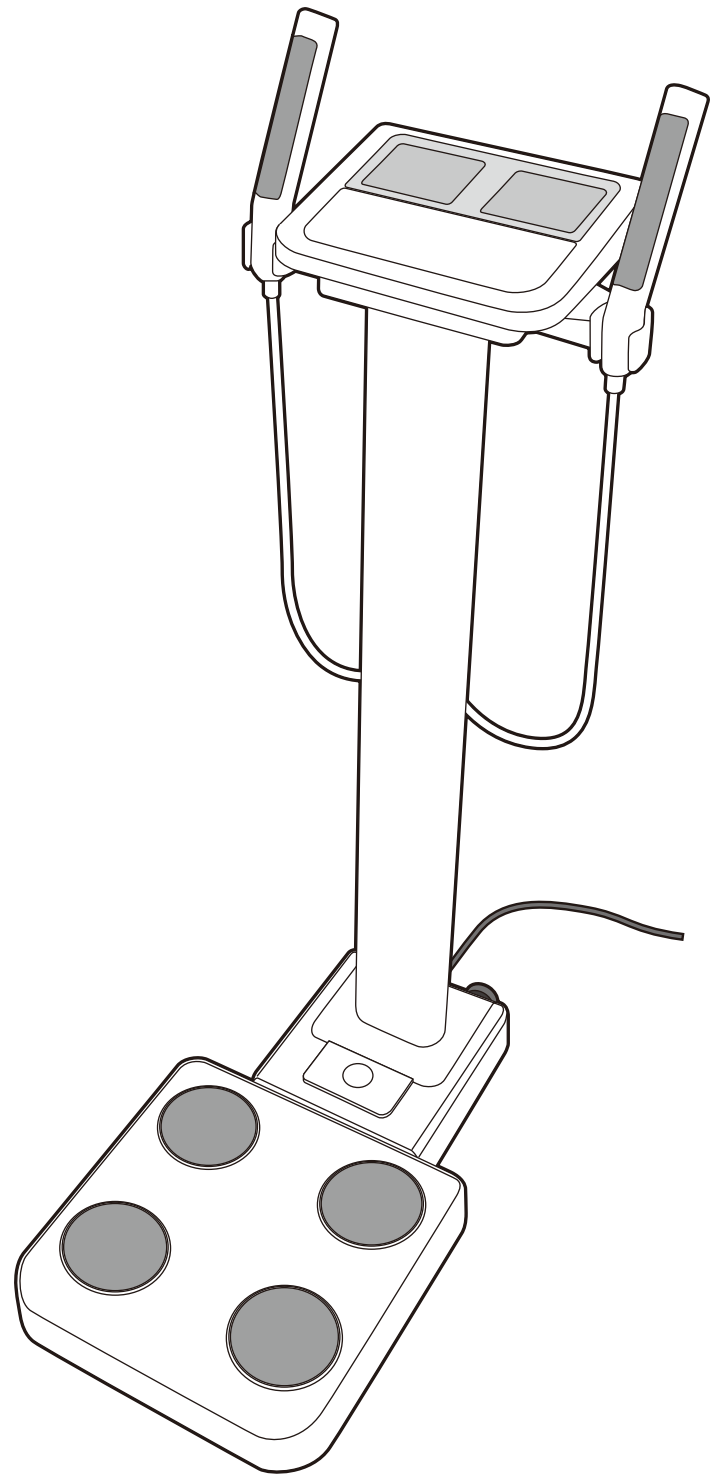

Power Supply

GB

Before Use
(cautions for safety)

Turning the main power ON/OFF

Turning the main power ON.

Press the  key to turn on the power.

The initial screen is displayed.

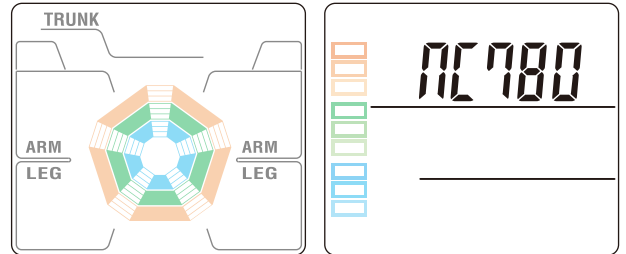

Turning the main power OFF.

Press the  key to turn the power off.

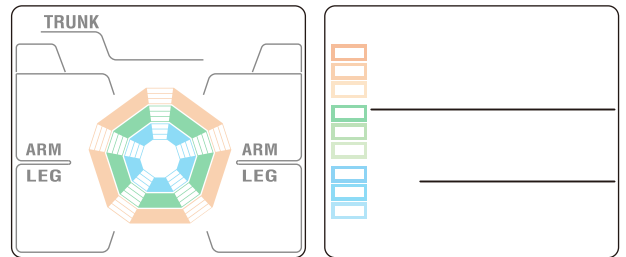

Emergency Shut Down

Keep the area around the plug socket clear during operation of the equipment in case of an emergency.

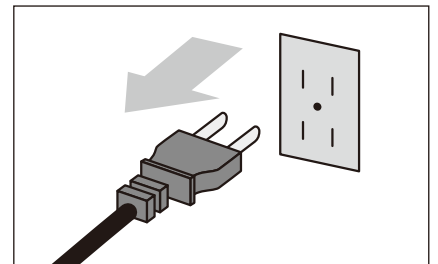

1 Press the  key to change the mode.

The setting screen is displayed.

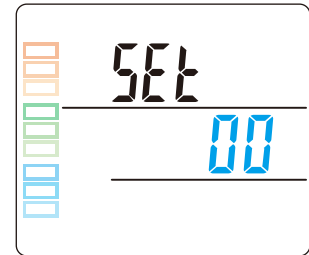

Note

•The  key cannot be used when the scale is measuring weight or impedance.

2 Select the setting item from the list below.
Enter numerical values and Press the  key.

Setting item List  → Save changes and return  → Return without saving

0	Check the software version	10	Height input unit (0: 0.1cm increments 1: 1cm increments) (Default:0)
1	Date and time * Date and time → Note	11	Automatic determination time of input information (0-9 second(s)) (Default:0) * 0: Disables this function
2	Number to be printed automatically (Body composition mode) (0-2 sheet(s)) (Default:0)	16	Unit change (0:off (kg) 1:on (lb)) (Default:1)
3	Number to be printed automatically (Scale mode and Weight lock mode) (0-2 sheet(s)) (Default:0)	18	Target body fat ratio input (0: off 1: on) (Default:0)
4	Select printing paper (0: Pre printed paper 1: Plain paper) (Default:1)	19	Printout language (1: English, 2: French, 3: Spanish) (Default:1)
5	Beep sound (0: off 1: on) (Default:1)	20	Adjudt printing position (2 : ↓ , 4 : ← , 6 : → , 8 : ↑)
6	ID number (Manual input) (0: off 1: on) (Default:0)	21	Timeout function of result display (0: disable 1: enable) (Default:0)
7	ID number (Automatic count up) (0: off 1: on) (Default:0)	31	Display direction (0: default 1: reversal position) (Default:0)
8	Measurement flow (0: Two step flow / Measure body weight first 1: One step flow / Enter personal info first) (Default:0) * Measurement flow → P.17	32	BMI desirable range (0: 18.5 to 25 1: 18.5 to 23) (Default:0)
9	Body type selection (Athletic mode) (0: off 1: on) (Default:0) * Athletic mode → P.17 & P.29	60	Reading stored measurement result → P.29

Note

Enter the year, month, day, hour and minute.
The date format is "yyyy mm dd hh:mm"

Example 6:47 pm, 24th September, 2012
"2012" "09 24" "18:47"

To enter a number with 1 digit (0 – 9), press "0" first.

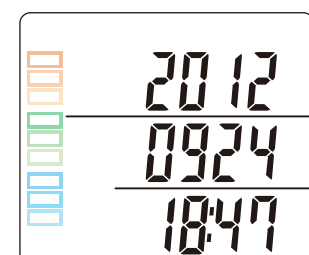



Settings (continued)

Select the Measurement Mode

Select the measurement mode by pressing the  key.

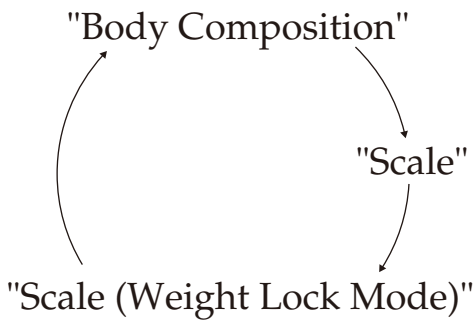
The measurement mode is switched in the following order when the  key is pressed:



The  mark is displayed when the scale mode is selected.

Body Composition Mode

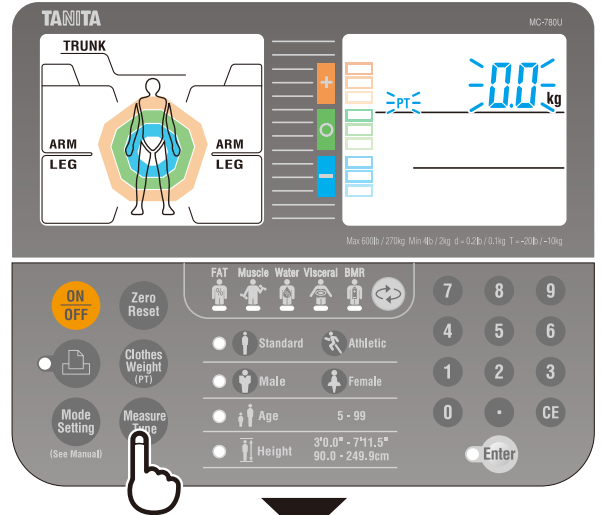

Scale Mode

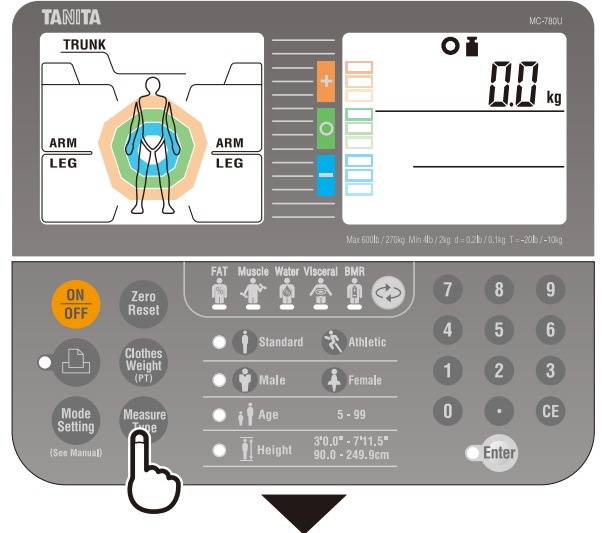

Scale Mode (Weight Lock Mode)

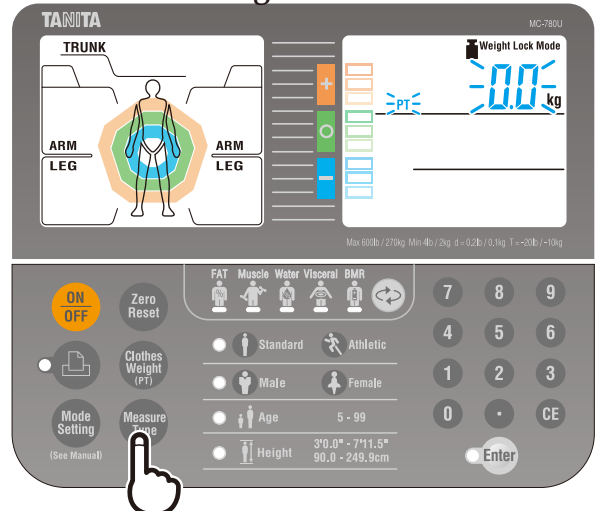

Taking a Measurement

GB

Body Composition Mode (Two step flow Measure body weight first)

HOW TO USE
(cautions for safety)

1 Enter the preset tare value (clothes weight)

Turn the power on, and check that the "PT" mark is displayed.
Enter the preset tare value (clothes weight)
The tare value range is 0.0-20.0lb (0.0 - 10.0kg)

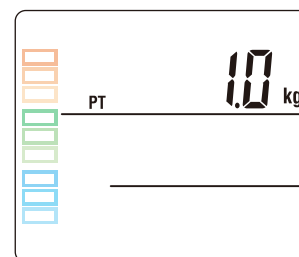
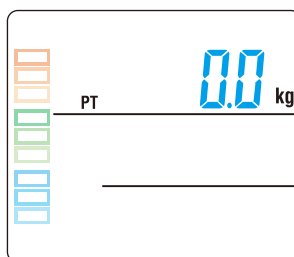

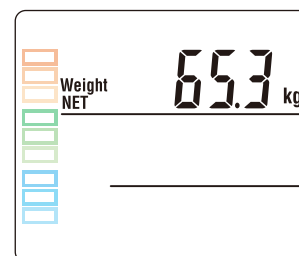
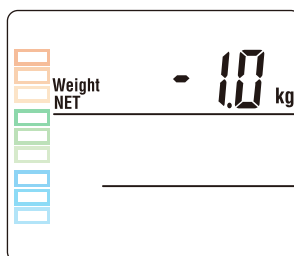

2 Measure body weight

Wait until "STEP ON" flashes.
"NET" is displayed when you have entered a tare value (clothes weight).



Note

When the One step flow is selected, enter personal information first. → P.15 Setting 8
If the scale does not detect a load, press  to switch to "Input tare value".
If the scale detects the load, press  to display the entered tare value.

3 Enter ID number

If the ID number function is set to OFF, the scale switches directly to "Select body type" without requesting an ID number.

The ID number range : 0 - 9999999999999999

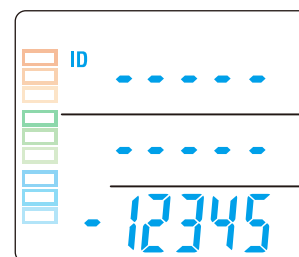

4 Select body type Standard Athletic

If the body type selection (Athletic mode) is set to OFF, the scale switches directly to "Select gender" without requesting a body type.

The "🏃" mark is displayed when the Athletic mode is selected.

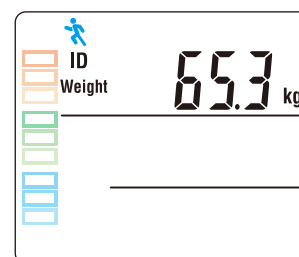

Note

Athletic mode setting → P.15 Setting 9
Athlete condition → P.29

Taking a Measurement (continued)

GB

Body Composition Mode (Two step flow Measure body weight first)

How to Use
(cautions for safety)

5 Select gender  Male  Female

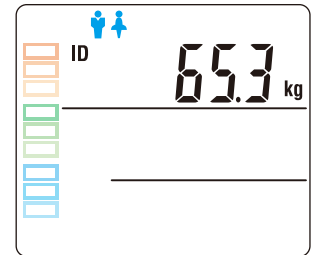

6 Enter age  Age

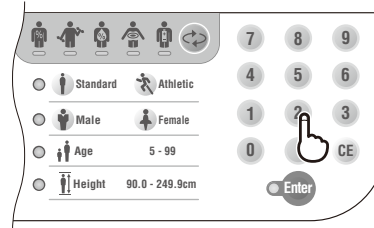

The age range : 5 - 99

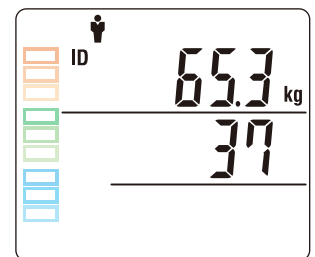

7 Enter height  Height

The height range :
3'0.0" - 7'11.5" / 90.0cm - 249.9cm

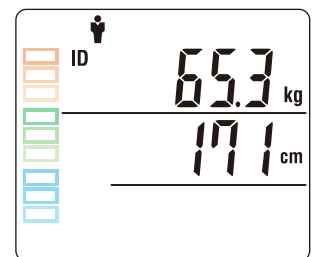
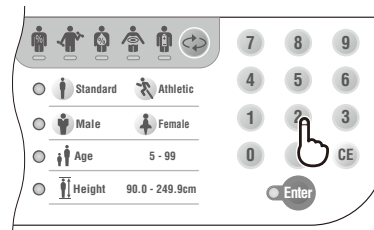

8 Set target body fat ratio

If the target body fat ratio function is set to OFF, the scale switches directly to "Measuring impedance" without entering the target value.

The body fat ratio range : 4 - 55 %

Note Target Body Fat → P.23

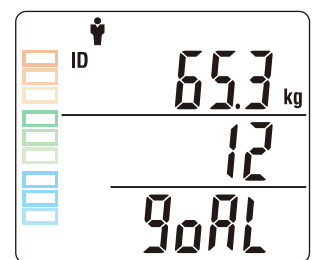

9 Measuring body composition

The scale starts measuring impedance after you have entered all of the personal information.

The segmental impedance values are measured in order.

The scale displays the measurement results after measuring the whole body impedance and segmental impedance.

The next measuring starts by pressing  Enter .

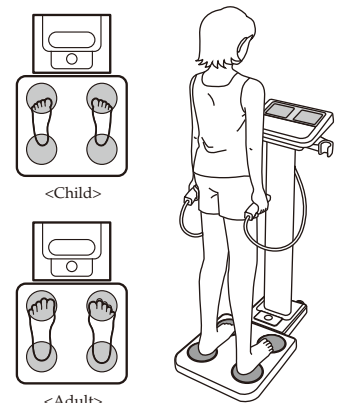

Measurement Results (Two step flow Measure body weight first)

Output Measurement Results (Body Composition Mode)

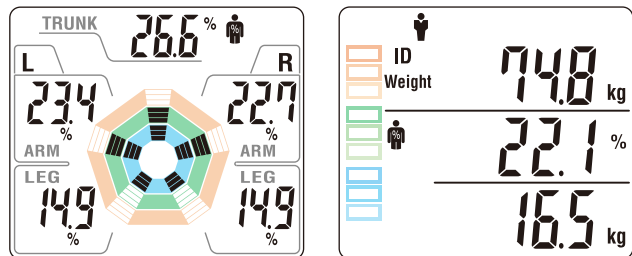

The measurement results are displayed on the LCD after measurement is completed. The results are output to the PC immediately after measurement is completed.

Press the key to select the measurement display.

The measurement display is switched in the following order by pressing the key.

"Fat" → "Muscle" → "Body Water" → "Visceral fat rating" → "Basal metabolic rate" → "BMI"

Body Fat (Applicable age : 5-99)

Fat icon

Segmental fat %

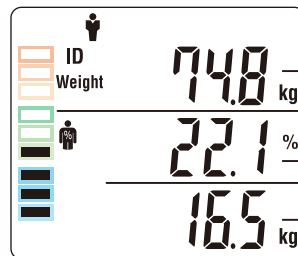
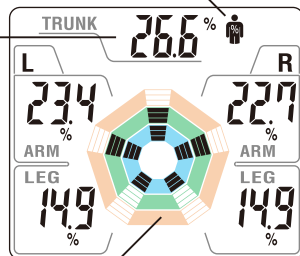

Body weight

Body fat %

Body fat mass

Evaluation of your results compared to average values.

Muscle (Applicable age : 18-99)

Muscle icon

Segmental Muscle Mass

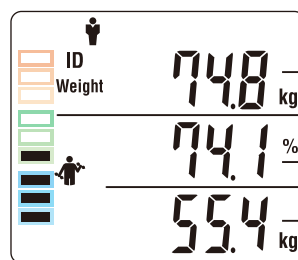
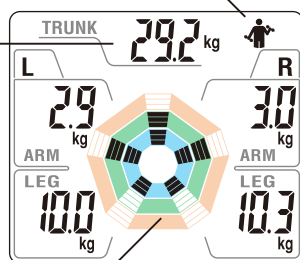

Body weight

Body muscle %

Body muscle mass

Evaluation of your results compared to average values.

Taking a Measurement (continued)

GB

Measurement Results (Two step flow Measure body weight first)

 **Body water** (Applicable age : 18-99)

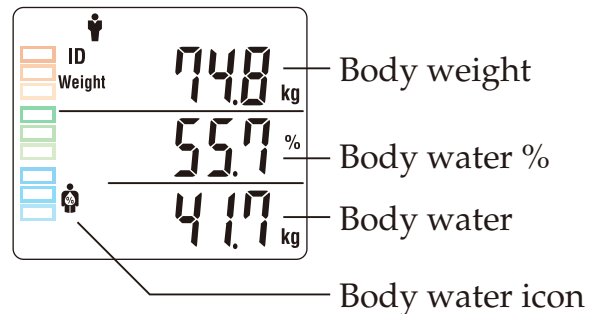

 **Visceral fat rating** (Applicable age : 18-99)

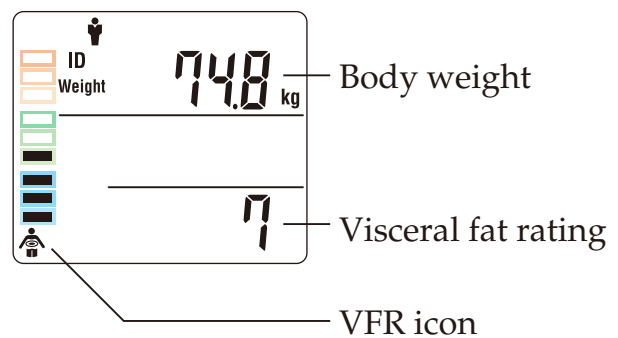

 **Basal metabolic rate** (Applicable age : 18-99)

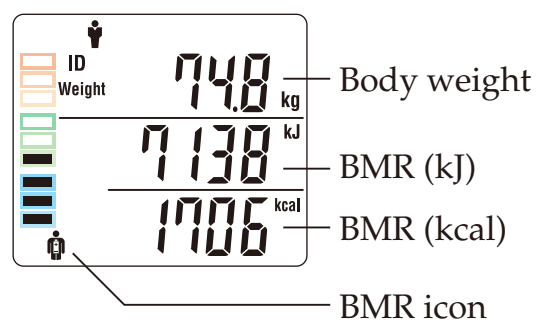

Body Mass Index (BMI) (Applicable age : 5-99)

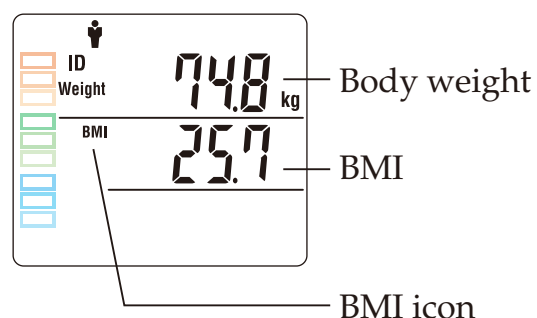

Scale Mode

The "⚖️" icon is displayed when the scale mode is selected.

1 Enter the ID number

If the ID number function is set to OFF, the scale starts measuring weight immediately.

Enter the ID number.

The ID number range is from 0 to 9999999999999999.

Press  to enter tare value (clothes weight).

The tare value range is 0.0-20.0lb (0.0 - 10.0kg).

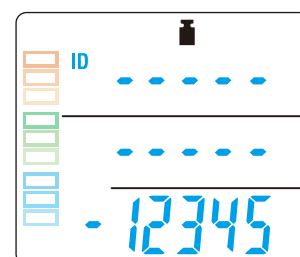

2 Measure body weight

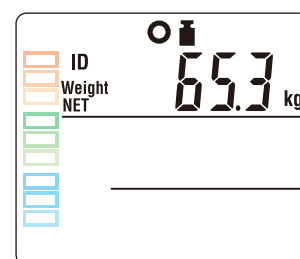
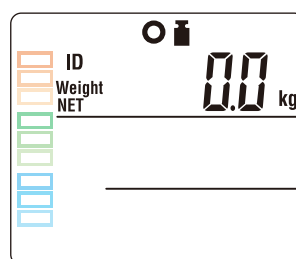

Wait until "STEP ON" flashes.

"NET" is displayed when you have entered a tare value (clothes weight).

The "Stabilised" icon (●) appears when the load is stable.

The "Stabilised" icon (○) disappears when the load is unstable.

When the load is stable, the measurement results are output via the USB port and stored on an SD card.

Taking a Measurement (continued)

GB

Weight Lock Mode

The "🔒" icon and "Weight Lock Mode" are displayed when the weight lock mode is selected.

Enter the preset tare value (clothes weight)

The "PT" is displayed after the scale mode is selected.

Enter the preset tare value (clothes weight)
The tare value range is 0.0-20.0lb (0.0 - 10.0kg).

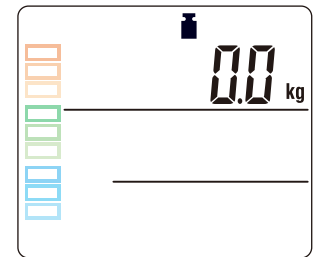
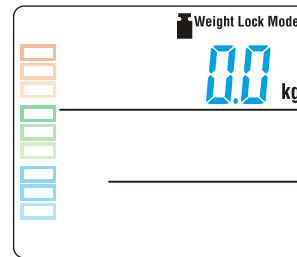

Enter the ID number

If the ID number function is set to OFF, the scale starts measuring weight immediately.

Enter the ID number.
The ID number range is from 0 to 9999999999999999.

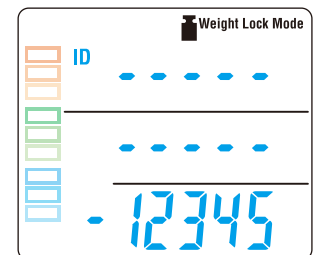

Measure body weight

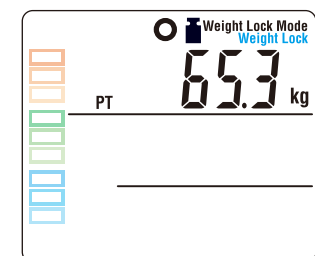
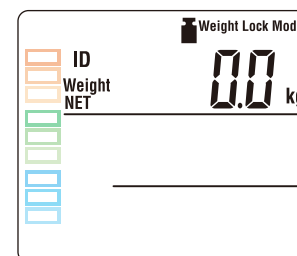

* "NET" is displayed when you have entered a tare value (clothes weight).

How to Use
(cautions for safety)

Various criteria

- What is body fat percentage? (Applicable age 5 - 99)

Body fat percentage is the amount of body fat as a proportion of your body weight.

Reducing excess levels of body fat has shown to reduce the risk of certain conditions such as high blood pressure, heart disease, diabetes and cancer. The chart below shows the healthy ranges for body fat.

Body Fat Ranges for Standard Children¹
Body Fat Ranges for Standard Adults²

¹ Susan Jebb et al. *Obesity Research* [o2] 2004;12:A156-157
"New Body Fat Reference Curves for children"

² Gallagher D et al. *Am J Clin Nutr* 2000;72:694-701.
"Healthy percentage body fat ranges: an approach for developing guidelines based on body mass index."

		Underfat								Healthy								Overfat								Obese																				
Female Age	5	1	2	3	4	5	6	7	8	9	10	11	12	13	14	15	16	17	18	19	20	21	22	23	24	25	26	27	28	29	30	31	32	33	34	35	36	37	38	39	40	41	42	43	44	45
	6	1	2	3	4	5	6	7	8	9	10	11	12	13	14	15	16	17	18	19	20	21	22	23	24	25	26	27	28	29	30	31	32	33	34	35	36	37	38	39	40	41	42	43	44	45
	7	1	2	3	4	5	6	7	8	9	10	11	12	13	14	15	16	17	18	19	20	21	22	23	24	25	26	27	28	29	30	31	32	33	34	35	36	37	38	39	40	41	42	43	44	45
	8	1	2	3	4	5	6	7	8	9	10	11	12	13	14	15	16	17	18	19	20	21	22	23	24	25	26	27	28	29	30	31	32	33	34	35	36	37	38	39	40	41	42	43	44	45
	9	1	2	3	4	5	6	7	8	9	10	11	12	13	14	15	16	17	18	19	20	21	22	23	24	25	26	27	28	29	30	31	32	33	34	35	36	37	38	39	40	41	42	43	44	45
	10	1	2	3	4	5	6	7	8	9	10	11	12	13	14	15	16	17	18	19	20	21	22	23	24	25	26	27	28	29	30	31	32	33	34	35	36	37	38	39	40	41	42	43	44	45
	11	1	2	3	4	5	6	7	8	9	10	11	12	13	14	15	16	17	18	19	20	21	22	23	24	25	26	27	28	29	30	31	32	33	34	35	36	37	38	39	40	41	42	43	44	45
	12	1	2	3	4	5	6	7	8	9	10	11	12	13	14	15	16	17	18	19	20	21	22	23	24	25	26	27	28	29	30	31	32	33	34	35	36	37	38	39	40	41	42	43	44	45
	13	1	2	3	4	5	6	7	8	9	10	11	12	13	14	15	16	17	18	19	20	21	22	23	24	25	26	27	28	29	30	31	32	33	34	35	36	37	38	39	40	41	42	43	44	45
	14	1	2	3	4	5	6	7	8	9	10	11	12	13	14	15	16	17	18	19	20	21	22	23	24	25	26	27	28	29	30	31	32	33	34	35	36	37	38	39	40	41	42	43	44	45
	15	1	2	3	4	5	6	7	8	9	10	11	12	13	14	15	16	17	18	19	20	21	22	23	24	25	26	27	28	29	30	31	32	33	34	35	36	37	38	39	40	41	42	43	44	45
	16	1	2	3	4	5	6	7	8	9	10	11	12	13	14	15	16	17	18	19	20	21	22	23	24	25	26	27	28	29	30	31	32	33	34	35	36	37	38	39	40	41	42	43	44	45
	17	1	2	3	4	5	6	7	8	9	10	11	12	13	14	15	16	17	18	19	20	21	22	23	24	25	26	27	28	29	30	31	32	33	34	35	36	37	38	39	40	41	42	43	44	45
	18	1	2	3	4	5	6	7	8	9	10	11	12	13	14	15	16	17	18	19	20	21	22	23	24	25	26	27	28	29	30	31	32	33	34	35	36	37	38	39	40	41	42	43	44	45
	19	1	2	3	4	5	6	7	8	9	10	11	12	13	14	15	16	17	18	19	20	21	22	23	24	25	26	27	28	29	30	31	32	33	34	35	36	37	38	39	40	41	42	43	44	45
	20-39	1	2	3	4	5	6	7	8	9	10	11	12	13	14	15	16	17	18	19	20	21	22	23	24	25	26	27	28	29	30	31	32	33	34	35	36	37	38	39	40	41	42	43	44	45
	40-59	1	2	3	4	5	6	7	8	9	10	11	12	13	14	15	16	17	18	19	20	21	22	23	24	25	26	27	28	29	30	31	32	33	34	35	36	37	38	39	40	41	42	43	44	45
	60-	1	2	3	4	5	6	7	8	9	10	11	12	13	14	15	16	17	18	19	20	21	22	23	24	25	26	27	28	29	30	31	32	33	34	35	36	37	38	39	40	41	42	43	44	45

		0%								10%								20%								30%								40%												
Male Age	5	1	2	3	4	5	6	7	8	9	10	11	12	13	14	15	16	17	18	19	20	21	22	23	24	25	26	27	28	29	30	31	32	33	34	35	36	37	38	39	40	41	42	43	44	45
	6	1	2	3	4	5	6	7	8	9	10	11	12	13	14	15	16	17	18	19	20	21	22	23	24	25	26	27	28	29	30	31	32	33	34	35	36	37	38	39	40	41	42	43	44	45
	7	1	2	3	4	5	6	7	8	9	10	11	12	13	14	15	16	17	18	19	20	21	22	23	24	25	26	27	28	29	30	31	32	33	34	35	36	37	38	39	40	41	42	43	44	45
	8	1	2	3	4	5	6	7	8	9	10	11	12	13	14	15	16	17	18	19	20	21	22	23	24	25	26	27	28	29	30	31	32	33	34	35	36	37	38	39	40	41	42	43	44	45
	9	1	2	3	4	5	6	7	8	9	10	11	12	13	14	15	16	17	18	19	20	21	22	23	24	25	26	27	28	29	30	31	32	33	34	35	36	37	38	39	40	41	42	43	44	45
	10	1	2	3	4	5	6	7	8	9	10	11	12	13	14	15	16	17	18	19	20	21	22	23	24	25	26	27	28	29	30	31	32	33	34	35	36	37	38	39	40	41	42	43	44	45
	11	1	2	3	4	5	6	7	8	9	10	11	12	13	14	15	16	17	18	19	20	21	22	23	24	25	26	27	28	29	30	31	32	33	34	35	36	37	38	39	40	41	42	43	44	45
	12	1	2	3	4	5	6	7	8	9	10	11	12	13	14	15	16	17	18	19	20	21	22	23	24	25	26	27	28	29	30	31	32	33	34	35	36	37	38	39	40	41	42	43	44	45
	13	1	2	3	4	5	6	7	8	9	10	11	12	13	14	15	16	17	18	19	20	21	22	23	24	25	26	27	28	29	30	31	32	33	34	35	36	37	38	39	40	41	42	43	44	45
	14	1	2	3	4	5	6	7	8	9	10	11	12	13	14	15	16	17	18	19	20	21	22	23	24	25	26	27	28	29	30	31	32	33	34	35	36	37	38	39	40	41	42	43	44	45
	15	1	2	3	4	5	6	7	8	9	10	11	12	13	14	15	16	17	18	19	20	21	22	23	24	25	26	27	28	29	30	31	32	33	34	35	36	37	38	39	40	41	42	43	44	45
	16	1	2	3	4	5	6	7	8	9	10	11	12	13	14	15	16	17	18	19	20	21	22	23	24	25	26	27	28	29	30	31	32	33	34	35	36	37	38	39	40	41	42	43	44	45
	17	1	2	3	4	5	6	7	8	9	10	11	12	13	14	15	16	17	18	19	20	21	22	23	24	25	26	27	28	29	30	31	32	33	34	35	36	37	38	39	40	41	42	43	44	45
	18	1	2	3	4	5	6	7	8	9	10	11	12	13	14	15	16	17	18	19	20	21	22	23	24	25	26	27	28	29	30	31	32	33	34	35	36	37	38	39	40	41	42	43	44	45
	19	1	2	3	4	5	6	7	8	9	10	11	12	13	14	15	16	17	18	19	20	21	22	23	24	25	26	27	28	29	30	31	32	33	34	35	36	37	38	39	40	41	42	43	44	45
	20-39	1	2	3	4	5	6	7	8	9	10	11	12	13	14	15	16	17	18	19	20	21	22	23	24	25	26	27	28	29	30	31	32	33	34	35	36	37	38	39	40	41	42	43	44	45
	40-59	1	2	3	4	5	6	7	8	9	10	11	12	13	14	15	16	17	18	19	20	21	22	23	24	25	26	27	28	29	30	31	32	33	34	35	36	37	38	39	40	41	42	43	44	45
	60-	1	2	3	4	5	6	7	8	9	10	11	12	13	14	15	16	17	18	19	20																									

Various criteria

GB

How to Use
(cautions for safety)

- What is total body water percentage? (Applicable age 18 - 99)

Total Body Water Percentage is the total amount of fluid in a person's body expressed as a percentage of their total weight.

Water plays a vital role in many of the body's processes and is found in every cell, tissue and organ. Maintaining a healthy total body water percentage will ensure the body functions efficiently and will reduce the risk of developing associated health problems.

Your body water levels naturally fluctuate throughout the day and night. Your body tends to be dehydrated after a long night and there are differences in fluid distribution between day and night. Eating large meals, drinking alcohol, menstruation, illness, exercising, and bathing may cause variations in your hydration levels.

Your body water percentage reading should act as a guide and should not be used to specifically determine your absolute recommended total body water percentage. It is important to look for long-term changes in total body water percentage and maintain a consistent, healthy total body water percentage.

Drinking a large quantity of water in one sitting will not instantly change your water level. In fact, it will increase your body fat reading due to the additional weight gain. Please monitor all readings over time to track the relative change.

Every individual varies but as a guide the average total body water percentage ranges for a healthy adult are:

Female: 45 to 60%

Male: 50 to 65%

Source: Based on Tanita's Internal Research

Note: The total body water percentage will tend to decrease as the percentage of body fat increases. A person with a high percentage of body fat may fall below the average body water percentage. As you lose body fat the total body water percentage should gradually move towards the typical range given above.

- What is visceral fat rating? (Applicable age 18 - 99)

This feature indicates the rating of visceral fat in your body.

Visceral fat is the fat that is in the internal abdominal cavity, surrounding the vital organs in the trunk (abdominal) area. Research shows that even if your weight and body fat remains constant, as you get older the distribution of fat changes and is more likely to shift to the trunk area especially post menopause. Ensuring you have healthy levels of visceral fat may reduce the risk of certain diseases such as heart disease, high blood pressure, and the onset of type 2 diabetes.

The Tanita Body Composition Analyzer will provide you with a visceral fat rating from 1 – 59.

Rating from 1 to 12

Indicates you have a healthy level of visceral fat. Continue monitoring your rating to ensure that it stays within the healthy range.

Rating from 13 – 59

Indicates you have an excess level of visceral fat. Consider making changes in your lifestyle possibly through diet changes or increasing exercise.

Source: 1) Tanita Institute Contract Study. Algorithm Development for Estimating Visceral Fat Rating. SB Heymsfield MD. Columbia University College of Physicians and Surgeons 2004.

2) Wang, Z., et al. Japanese-American Differences in Visceral Adiposity and a Simplified Estimation Method for Visceral Adipose Tissue. North American Association for the Study of Obesity. Annual Meeting. Abstract 518-P. 2004

Note:

- Even if you have a low body fat rate, you may have a high visceral fat level.
- For medical diagnosis, consult a physician.

- What is basal metabolic rate (BMR)? (Applicable age 18 - 99)

WHAT IS BMR?

Your Basal Metabolic Rate (BMR) is the minimum level of energy your body needs when at rest to function effectively including your respiratory and circulatory organs, neural system, liver, kidneys, and other organs. You burn calories when sleeping.

About 70% of calories consumed every day are used for your basal metabolism. In addition, energy is used when doing any kind of activity however; the more vigorous the activity is the more calories are burned. This is because skeletal muscle (which accounts for approximately 40% of your body weight) acts as your metabolic engine and uses a large amount of energy. Your basal metabolism is greatly affected by the quantity of muscles you have, therefore increasing your muscle mass will help increase your basal metabolism.

By studying healthy individuals, scientists have found that as people age, their metabolic rate changes. Basal metabolism rises as a child matures. After a peak at the age of 16 or 17, it typically starts to decrease gradually.

Having a higher basal metabolism will increase the number of calories used and help to decrease the amount of body fat. A low basal metabolic rate will make it harder to lose body fat and overall weight.

HOW DOES A TANITA BODY COMPOSITION ANALYZER CALCULATE BMR?

The basic way of calculating Basal Metabolic Rate (BMR) is a standard equation using weight and age. Tanita has conducted in-depth research into the relationship of BMR and body composition giving a much more accurate and personalized reading for the user based on the impedance measurement. This method has been medically validated using indirect calorimetry (measuring the breath composition).*

* Reliability on equation for Basal Metabolic Rate: At 2002 Nutrition Week : A Scientific and Clinical Forum and Exposition Title: International Comparison: Resting Energy Expenditure Prediction Models: The American Journal of Clinical Nutrition

Various criteria

GB

How to Use
(cautions for safety)

- What is muscle mass? (Applicable age 18 - 99)

This feature indicates the weight of muscle in your body. the muscle mass displayed includes the skeletal muscles, smooth muscles (such as cardiac and digestive muscles) and the water contained in these muscles.

Muscles play an important role as they act as an engine in consuming energy. As your muscle mass increase, your energy consumption increases helping you reduce excess body fat levels and lose weight in a healthy way.

What is physique rating?

This feature assesses your physique according to the ratio of body fat and muscle mass in your body. As you become more active and reduce the amount of body fat, your physique rating will also change accordingly. Even though your weight may not change, your muscle mass and body fat levels may be changing making you healthier and at lower risk of certain diseases.

Each person should set their own goal of which physique they would like and follow a diet and fitness program to meet that goal.

Result	Physique Rating	Explanation
1	Hidden obese	Small Frame Obese
		This person seems to have a healthy body type based on physical appearance; however, they have a high body fat % with low muscle mass level.
2	Obese	Medium Frame Obese
		This person has a high body fat percentage, with a moderate muscle mass level.
3	Solidly-built	Large Frame Obese
		This person has both a high body fat % and a high muscle mass.
4	Under exercised	Low Muscle & Average Body Fat%
		This person has an average body fat % and a less than average muscle mass level
5	Standard	Ave. Muscle & Ave. Body Fat %
		This person has average levels of both body fat and muscle mass.
6	Standard Muscular	High Muscle & Ave. Body Fat % (Athlete)
		This person has an average body fat % and higher than normal muscle mass level.
7	Thin	Low Muscle & Low Fat
		This person has both a lower than normal body fat % and muscle mass level.
8	Thin and muscular	Thin and muscular (Athlete)
		This person has lower than normal body fat % while having adequate muscle mass.
9	Very Muscular	Very Muscular (Athlete)
		This person has lower than normal body fat % while having above average muscle mass.

Source : Data from Columbia University (New York) & Tanita Institute (Tokyo)

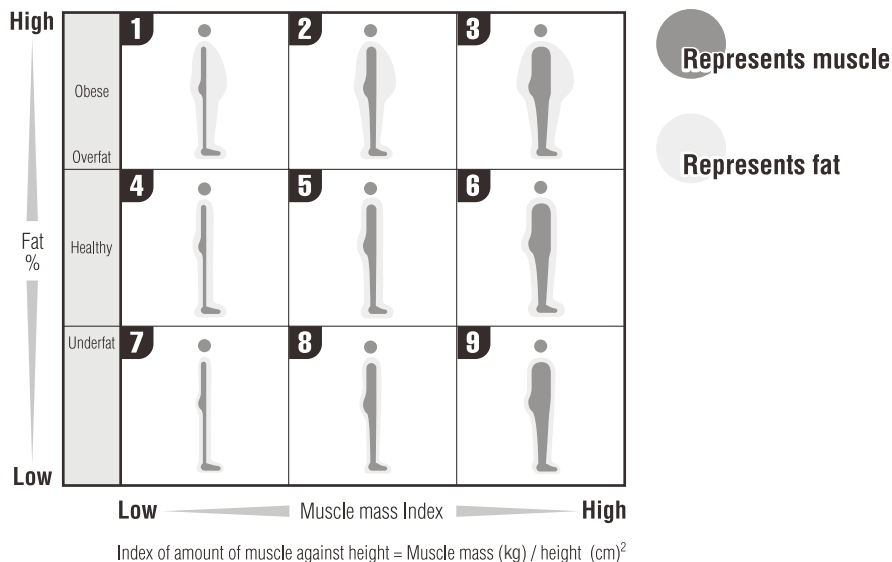

- What is bone mass? (Applicable age 18 - 99)

This feature indicates the amount of bone (bone mineral level, calcium or other minerals) in the body. Research has shown that exercise and the development of muscle tissue are related to stronger, healthier bones. While bone structure is unlikely to make noticeable changes in a short period, it is important that you develop and maintain healthy bones by having a balanced diet and plenty of exercise. People worried about bone disease should consult their physician. People who suffer from osteoporosis or low bone densities due to advanced age, young age, pregnancy, hormonal treatment or other causes, may not get accurate estimations of their bone mass.

Below is the result of estimated bone masses of persons aged 20 to 40, who are said to have the largest amounts of bone masses, by weight. (Source : Tanita Body Weight Science Institute)

Please use the below charts as a guide to compare your bone mass reading.

Women : Average of estimated bone mass

Weight (lb)		
Less than 110 lb	110lb - 165 lb	165 lb and up
4.3 lb	5.3 lb	6.5 lb

Weight (kg)		
Less than 50 kg	50 kg - 75 kg	75 kg and up
1,95 kg	2,40 kg	2,95 kg

Men : Average of estimated bone mass

Weight (lb)		
Less than 143 lb	143 lb - 209 lb	209 lb and up
5.9 lb	7.3 lb	8.1 lb

Weight (kg)		
Less than 65 kg	65 kg - 95 kg	95 kg and up
2,66 kg	3,29 kg	3,69 kg

Note: Persons described below may obtain varying readings and should take the values given for reference purposes only.

- Elderly persons - Women during or after menopause
- People receiving hormone therapy

"Estimated bone mass" is a value estimated statistically based on its correlation with the fat-free amount (tissues other than the fat). "Estimated bone mass" does not give a direct judgment on the hardness or strength of the bones or the risks of bone fractures. If you have concerns over your bones, you are recommended to consult a specialist physician.

Output and Storage of Measurement Results

GB

Data Output

Outputting measurement results via the USB or RS

The results are output to the PC immediately after measurement is completed.

Data is output in CSV format.

- USB connector (B - Type 4 - pin female) are located on the back of the control box.
- Please provide your own cable as necessary as none are included.

USB cable : A - Type 4 - pin (male) - B - Type 4 - pin (male)

- You must install the necessary driver onto your PC, available download from <http://www.tanita.com>.

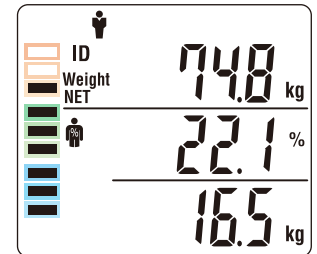
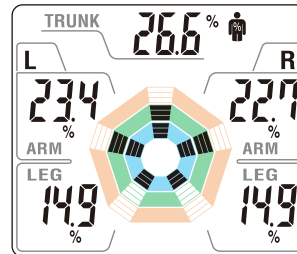

Data Storage

Data storage of measurement results

The results are saved to the SD card immediately after measurement is completed.

The  icon is displayed when a valid SD card is installed.

A new file is created on the SD card for each day.

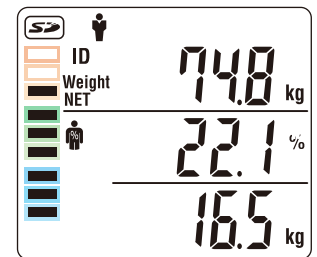
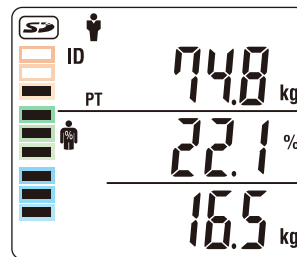

The file is created using the measurement date and time as the file name, as shown below. "YYYYMMDD" (year, month and date)

If "error 12" is shown in the display, this indicates that there is not enough free space left on the SD card.

You can store approximately 10,000 measurement results (weight only mode) on a 2GB SD card.

- Do not remove the SD card when it is storing or reading data.
- Do not turn off the main power when the SD card is storing or reading data.

Printing Data

Printing Measurement Results

The results are printed from the printer immediately after measurement is completed.

The number of sheets that are printed is set in .

Press the  key to print additional copies.

You can print out the result if  is lighted.

Output and Storage of Measurement Results (continued)

GB

Reading stored measurement result data

Reading stored measurement result data (→P.15 Setting 60)

Select the file that you want to load using the  or  key and  or  key and press .

Displaying stored data

Date and time when the displayed data was measured

Year, Month and Date

Hour, Minute and Second

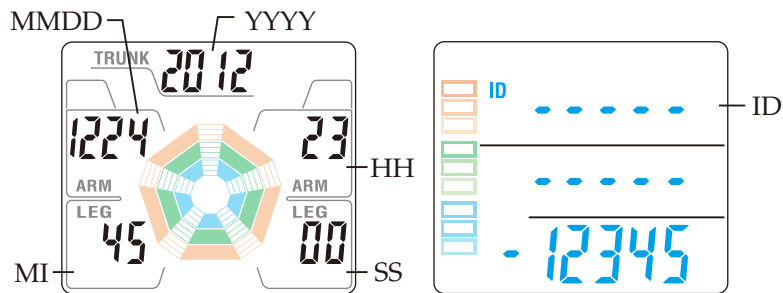

Switch the display by pressing the  key.

 → Print

 → Next data

 → Exit

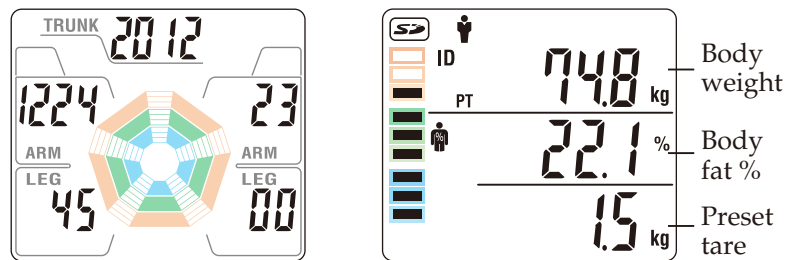

General Instructions for Body Composition Measurement

Athletic Mode

• Recommended for those who are 18 years or older and meet the following conditions.

- People who carry out 12 hours or more of cardiovascular exercise a week.
- People who belong to a sport team or a sport organization with the aim of participation in competition, etc.
- People who are professional athletes.

Target Body Fat

• A target body fat % should be set by a professional only. Tanita is not responsible for setting the appropriate target body fat % for specific individuals.

Attention

• Posture when measuring

- Stand with both feet parallel on the electrodes.
- Stand without bending knees.

• The age input range is 5 – 99 years old.

Input age 99 for those who are 100 years or older.

Note

- Inaccurate results may be reported after excessive food/fluid intake, or after periods of intense exercise.
- If clothes weight is input, clothes weight is subtracted from the weight measurements.

How to Use
(cautions for safety)

Troubleshooting

GB

Please check the following before requesting repair.

If Necessary
(cautions for safety)

	Problem	Solution
Measurement	Error with impedance measurement	<ul style="list-style-type: none"> • Hold the handgrips and electrodes firmly with fingers and palms. • Stand barefoot on the platform for measurement. • If the soles of the feet are dry, use the included dropper to apply about 0.5 ml of water before measurement. • Check the input details.
	Error with zeroing	<ul style="list-style-type: none"> • Turn off the power and remove anything on the platform, then turn on the power and try measuring again.
	The weight value does not stabilize.	<ul style="list-style-type: none"> • Is the equipment placed on a vibrating surface? • Is the measuring platform tilted? • Is something blocking the gap in the measuring platform? • Remove any inserted objects.
Display	Nothing is displayed, even when the power is turned on.	<ul style="list-style-type: none"> • Confirm that the power is connected correctly.
	"-----" is displayed.	<ul style="list-style-type: none"> • The measured weight exceeds weighing capacity.

Body composition measurement by the BIA method.

Introduction

This equipment provides estimated values for each measured value of body fat percentage, fat mass, fatfree mass, muscle mass and bone mass by the DXA method, estimated value for the total body water measured value by the dilution method and estimated value for the visceral fat rating by MRI method using the Bioelectrical Impedance Analysis (BIA method).

For measurement, a mode must be selected based on body type.

1) Standard (for 5-99 years of age)

2) Athletic (for Athletic persons who exercise considerably more than non-athlete)

Making a distinction by body type in the measurement mode produces more reliable body composition measurements for athletic persons, whose body compositions differ from those of average persons.

- Principles of body composition measurement

BIA is a means of measuring body composition – fat mass, predicted muscle mass, etc. – by measuring bioelectrical impedance in the body. Fat within the body allows almost no electricity to pass through, while electricity passes rather easily through water, much of which is found in muscles. The degree of difficulty with which electricity passes through a substance is known as the electrical resistance, and the percentage of fat and other body constituents can be inferred from measurements of this resistance.

The Tanita Body Composition Analyzer measures body composition using a constant current source with a high frequency current (50kHz, 90 μ A). The 8 electrodes are positioned so that electric current is supplied from the electrodes on the tips of the toes of both feet, and voltage is measured on the heel of both feet. The current flows into the upper limbs or lower limbs, depending on the body part(s) to be measured.

- What is the DXA method?

DXA was originally designed to measure bone mineral content, but in the full-body scan mode the body fat percentage, fat mass, and fat free mass of individual body parts (arms, legs, trunk) can also be measured. The image below shows one example of body composition measurement results obtained by DXA.

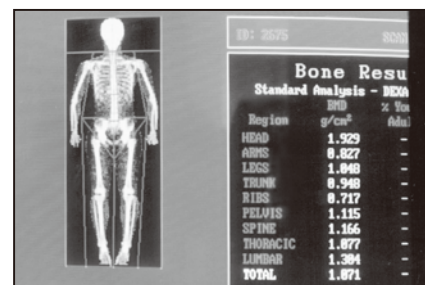

Region	BMD g/cm ²	% Tot Adm
HEAD	1.929	-
ARMS	0.627	-
LEGS	1.048	-
TRUNK	0.948	-
RIBS	0.717	-
PELVIS	1.115	-
SPINE	1.166	-
THORACIC	1.077	-
LUMBAR	1.394	-
TOTAL	1.071	-

Body composition measurement results obtained by DXA (Lunar Co., Ltd; DPX-L)

- What is dilution method?

In the dilution method, a labeled substance for a known amount is given and the concentration in equilibrium diffusing evenly is measured to obtain the total amount of the solvent that dilutes the labeled substance.

To measure the total body water (TBW), deuterium oxide (D₂O) is generally used as the labeled substance. Deuterium oxide uses the overall total body water as dilution space so the total body water can be obtained. To obtain the extracellular fluid amount, sodium bromide (NaBr) is used as a labeled substance. Bromine (Br) is said to not enter the inside of cells, and uses extracellular fluid as the dilution space.

Technical notes

- What is the visceral fat?

Visceral Adipose Tissue (VAT) has been associated with increased risk of developing lifestyle-related diseases. Accordingly, knowing and periodically checking the estimated VAT accumulation serves as one factor of a number of factors in assessing the prevention of lifestyle related diseases.

Tanita has developed the technology for measuring the VAT accumulation risk through bioelectrical impedance analysis (BIA) in comparison with image analysis applied to magnetic resonance imaging (MRI), in addition to the established technology for measuring the percent of body fat. The VAT accumulation risk is calculated by estimating the VAT area by the BIA method on the basis of MRI image processing. This method has a higher correlation than the estimation of the VAT accumulation risk based on BMI or abdominal circumference (waist circumference), allowing estimation that corresponds more precisely to individuals.

* The VAT area by MRI is calculated by carrying out an image processing of the cross section of the lumbar vertebra L4-L5 regions.

(Fig. 1 - Fig. 3: Research results by N. Y. Columbia University and Jikei University Published by the North American Association for the Study of Obesity [NAASO] in 2004.)

<Fig. 1> Relationship between VAT Area and BMI

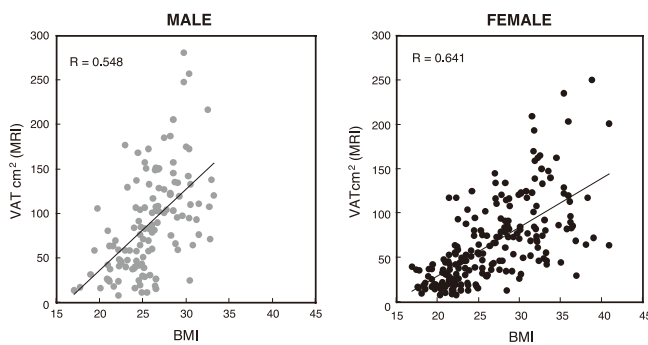

<Fig. 2> Relationship between VAT Area and Waist Circumference

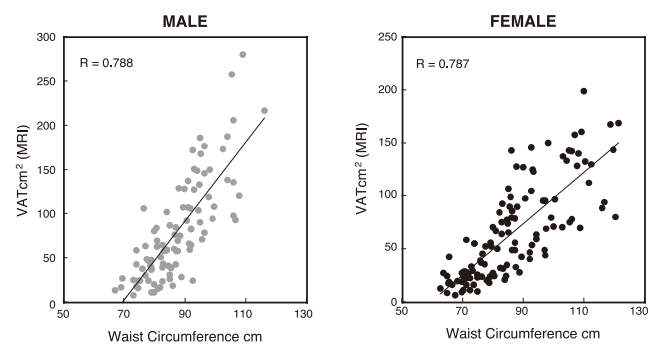

<Fig. 3> Relationship between VAT Area by MRI and Estimated VAT Area by Tanita's BIA

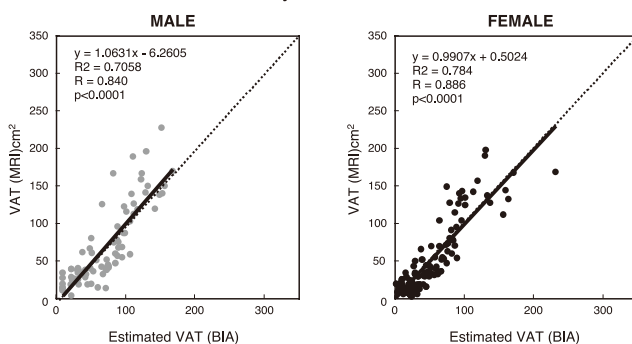

If Necessary
(cautions for safety)

- Factors giving errors in measurement

In the BIA method, impedance is measured and the body composition is calculated based on the value. It is known that impedance changes by the amount of the total body water that occupies about 60% of weight and the change in its distribution and temperature change. Therefore, for the purpose of research or for daily repeating of measurements, the measurement conditions must be kept constant. Measurement under the changing conditions of temperature and total body water distribution or blood flow volume of extremities due to exercising, taking a bath, etc., affects the measurement result since the electric resistance in the body also changes.

Therefore, it is recommended to measure under the following conditions for stable measurement.

- 1) 3 hours have passed after getting up and normal lifestyle activities are carried out during this period. (The impedance transits staying at a high level if you remain sitting after getting up or drive a car, etc.)
- 2) 3 hours or more have passed after eating. (For 2 – 3 hours after eating, the impedance has a tendency to decrease.)
- 3) 12 hours or more have passed after vigorous exercise for measurement. (The tendency toward changes in impedance is not stable depending on the type and rigorousness of the exercise.)
- 4) If possible urinate before taking measurement.
- 5) For repeated measurements, measure at the same hour as much as possible. (At the same time of measurement of weight, the measurements can be made more stable by measuring at the same time of the day)

Very stable measured values can be obtained by measuring under the above conditions.

And in the development of this equipment, the following 6 items were set as conditions for the regression equation.

- 1) Prohibition of alcohol intake for 12 hours before measurement
- 2) Prohibition of excessive exercise for 12 hours before measurement.
- 3) Prohibition of excessive eating and drinking the day before measurement
- 4) Prohibition of eating and drinking for 3 hours before measurement
- 5) Urination just before measurement
- 6) Avoid measurements during menstruation (for female)

2) Inter-day changes

The diagrams below offer examples of actual measurements made of inter-day changes. A study was done to determine the degree of change in the impedance between the feet during dehydration; the first two days represent a normal daily routine, while in the latter two days a state of dehydration was induced using a sauna.

No significant inter-day change was measured in body weight, impedance between the feet, or body fat percentage during the normal daily routine. During the dehydrated state, however, a drop in body weight of 1kg was noted, with the impedance between the feet rising approximately 15Ω on the first day of dehydration and $30\text{--}35\Omega$ on the second day. As a result, body fat percentage was up by around 1% on the first day of dehydration and by 1.5-2% on the second day.

As mentioned earlier, impedance increases when body weight is reduced (such as by dehydration), and decreases when body weight is increased through excess consumption of food and drink. The inter-day change in impedance is thus inversely proportional to the change in body weight.

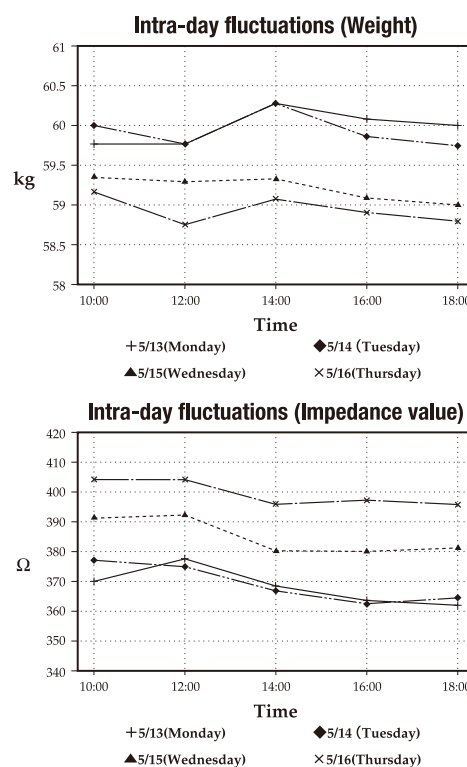

Technical notes

GB

These inter-day changes stem from such causes as:

- 1) Temporary increases in body weight (total body water) through overeating and overdrinking
- 2) Dehydration due to heavy sweating during vigorous exercise
- 3) Dehydration due to alcohol consumption or the use of diuretics
- 4) Dehydration due to heavy sweating during saunas, etc.

Accordingly, it is recommended that instructions be provided to the subject to help eliminate these causes when accurate measurements are needed.

If Necessary
(cautions for safety)

The Regression Formula for Basal Metabolic Rate (BMR)

It has long been said among medical and nutritional specialists that "The Basal Metabolic Rate (BMR) is more determined by the Fat Free Mass (FFM) than by the body weight" (Persons of a given body weight with a higher FFM will have a higher BMR), and that from the aspect of evaluating the body composition, should be estimated from the FFM. In addition, in cases of simple estimation formulae which can calculate from the height, weight and age, without evaluating the body composition, there was a problem with excessively high evaluations being given to obese persons with large body weight, and conversely excessively small BMR evaluations given to muscular athletes, though these are not as many in number. Currently, the BMR estimation recursion formula developed by Tanita, the manufacturer of body composition analyzers, based on their research, works by multiple regressive analysis using this FFM, and has a higher degree of accuracy in the individual differences in body composition. In order to derive the BMR, resting respiratory metabolism (Resting Energy Expenditure: REE) was measured using a breath gas analysis device, and this estimation recursion formula was created based on this data.

<Figure 1> The Relationship Between Resting Energy Expenditure (REE) According to Breath Gas Analysis and Weight, FFM

(Presented at Nutrition Week, Held in San Diego in 2002)

As shown in Figure 1: the REE (BMR) has a stronger relationship to the FFM than to body weight, and a difference is visible between males and females in the distribution trends. We see that in principle that we should calculate from the FFM rather than by the old formula centred on the relationship with weight.

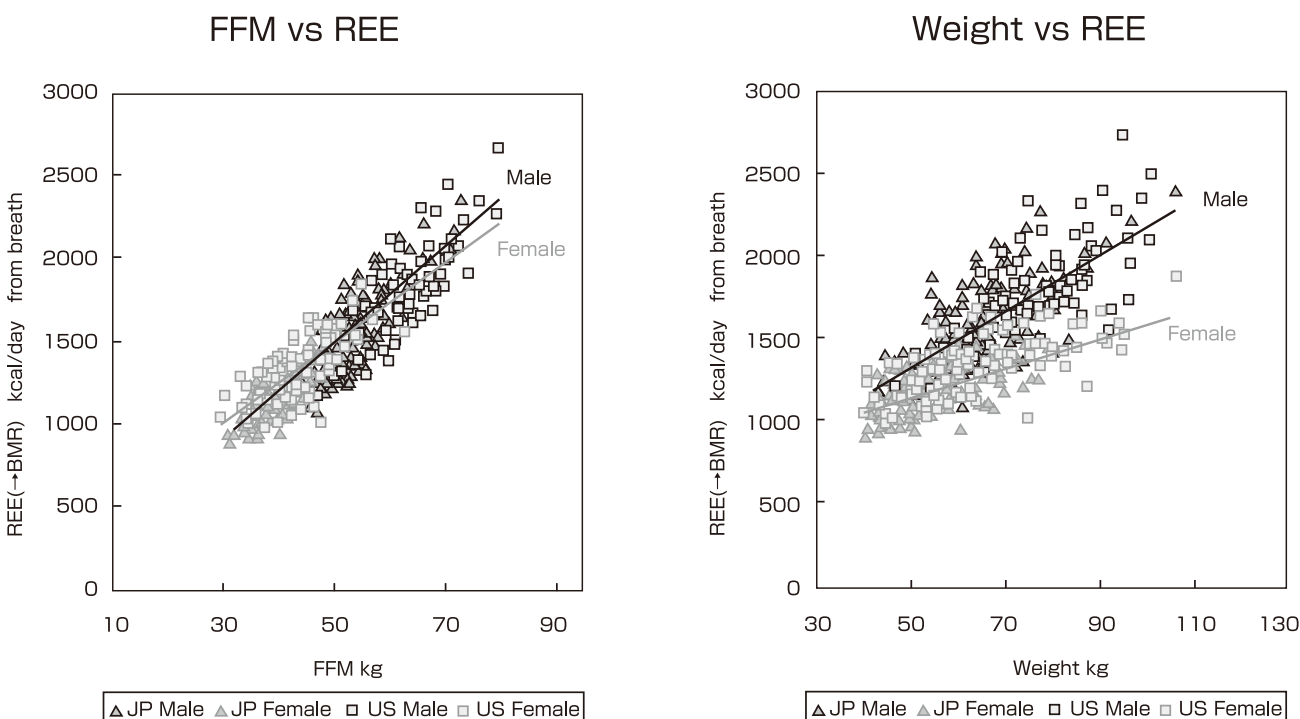

The Regression Formula for Basal Metabolic Rate (BMR)

<Figure 2> Comparison of BMR Values from the TANITA Multiple regression model and Breath Analysis

(Presented at Nutrition Week Held in San Diego in 2002)

The current BMR retrogression formula is a formula which acts on the principle of using the FFM value from the results of body composition measurement according to the BIA. A good relationship is shown in the BMR value based on actual breath analysis REE or $R=0.9$ ($p<0.0001$). These results were presented at the First Annual Nutrition Week (American College of Nutrition, American Society for Clinical Nutrition, American Society for Parenteral and Enteral Nutrition, North American Association for the Study of Obesity) held in 2002 in San Diego.

NOTE: This model has been calibrated for those between ages of 18-84. Those individuals outside of this age range may not be obtain accurate readings.

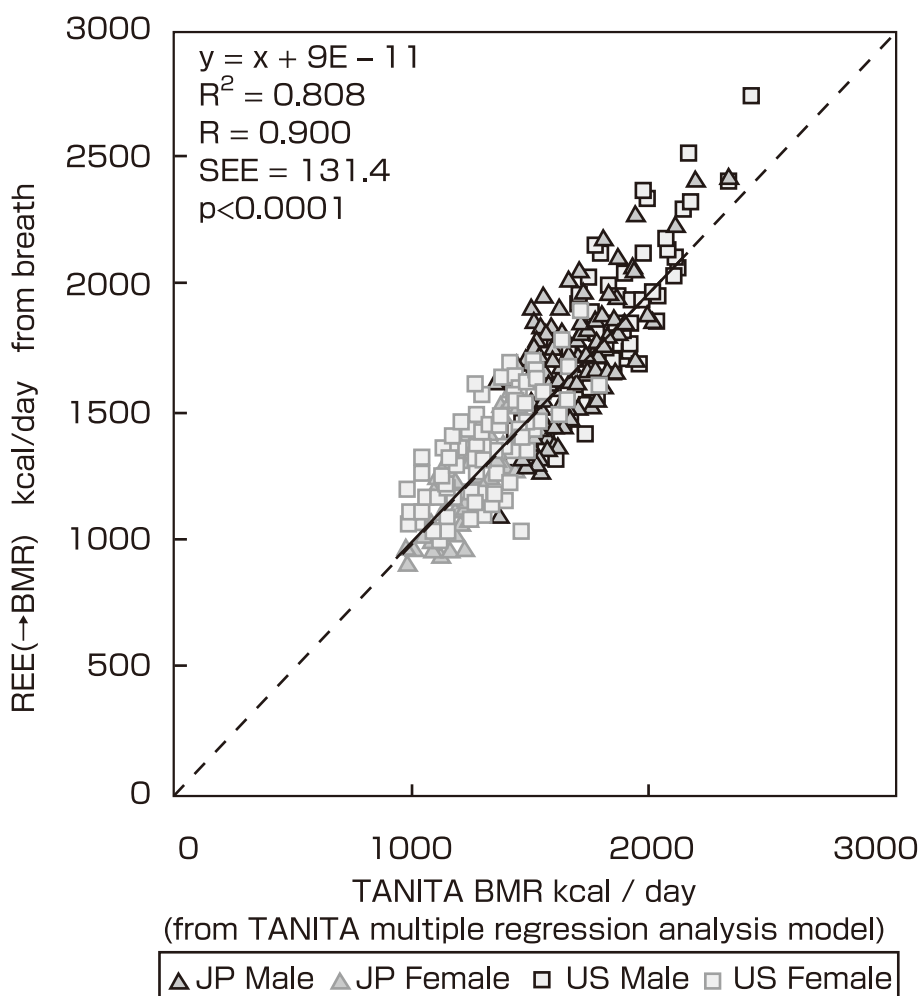

If Necessary
(cautions for safety)

GB

Specifications

GB

If Necessary
(cautions for safety)

Model Number		MC-780U
Power Source		100 - 240V AC
Electric Current Range		18VA
Impedance Measurement	Measurement System	Multi-Frequency 8 Electrode
	Measurement Frequency	5kHz/50kHz/250kHz
	Measurement Current	Up to 90 μ A
	Electrode Materials	Feet: Stainless steel/Handgrips: plated
	Measurement Part	Whole body/Right arm/Left arm/Right leg/Left leg
	Measurement Range	75.0 Ω - 1,500.0 Ω (0.1 Ω increments)
	Accuracy at First Calibration	\pm 2%
Weight Measurement	Measurement System	Strain Gauge Load Cell
	Maximum Capacity	600lb (270kg) (including preset tare value)
	Minimum Graduation	0.2lb (0.1kg)
	Accuracy at First Calibration	\pm 0.4lb (0.2kg)
Display		Dual LCD screen
Interface		USB B-type connector (device)
		RS-232C
		USB mini-B (for PictBridge printer)
		SD card*4
Usage Conditions	Temperature	32°F - 95°F (5°C - 35°C)
	Relative humidity	30% - 80% (without condensation)
Product Weight		34.2lb/15.5kg
Product Size	Platform	Platform size: 14.1in x14.1in (360mm x360mm) Height: 3.7in(94mm)
	Product Height	45.8in(1165mm)

Input items	Clothes Weight	0lb-20.0lb (0.2lb increments) / 0kg-10.0kg (0.1kg increments)	
	Serial No.	Up to 16 digits	
	Gender	Female/Male	
	Body Type	Standard/Athletic* ¹	
	Age	5 - 99 years	
	Height	3'0.0" - 7'11.5" (0.5inch increments) / 90.0 -249.9cm (0.1cm increments)	
	Target Body fat %	4 - 55% (1% increments)	
Output items	ID	16 digits	
	Gender	Female/Male	
	Body Type	Standard/Athletic * ¹	
	Age	5 - 99 years	
	Height	3'0.0"-7'11.5" (0.5inch increments) / 90.0 -249.9cm (0.1cm increments)	
	Clothes Weight	0lb-20.0lb (0.2lb increments) / 0kg-10.0kg (0.1kg increments)	
	Whole Body Analysis	Weight	0lb - 600lb (0.2lb increments) / 0kg - 270kg (0.1kg increments)
		Fat %	1.0% - 75.0% (0.1% increments)
		Fat Mass*³	0.2lb increments / 0.1kg increments
		FFM*³	0.2lb increments / 0.1kg increments
		Muscle Mass*^{2*3}	0.2lb increments / 0.1kg increments
		BMI	0.1 increments
		Bone Mass*^{2*3}	0.2lb increments / 0.1kg increments
		Basal Metabolic Rate*²	1kcal/1kJ increments
		Visceral Fat Rating*²	1 - 55 (1 increments)
		TBW*^{2*3}	0.2lb increments / 0.1kg increments
		TBW %*²	0.1% increments
		ECW*²	0.2lb increments / 0.1kg increments
		ICW*²	0.2lb increments / 0.1kg increments
		ECW / TBW*²	0.1% increments
	Segmental Analysis	Muscle Mass*^{2*3}	0.2lb increments / 0.1kg increments
		Muscle Mass Rating*²	-4 - +4 (1 increments)
		Fat %	0.1% increments
Fat Mass*³		0.2lb increments / 0.1kg increments	
Fat Rating*²		-4 - +4 (1 increments)	
Body Balance Evaluation	Physique Rating*²		
	Muscle Mass Balance*²		
Others	Bioelectrical data	Reactance/Resistance/Phase Angle	

*1 Athletic mode can be selected only for ages 18-99.

*2 18-99 years

*3 Calculated value

*4 Compatible with SD and SDHC memory cards

Note

Not compatible with SDXC memory cards

USA and Canada

Federal Communications Commission and Canadian ICES Notice

This equipment has been tested and found to comply with the limits for a Class B digital device, pursuant to Part 15 of the FCC Rules and Canadian ICES-003. These limits are designed to provide reasonable protection against harmful interference in a residential installation. This equipment generates, uses and can radiate radio frequency energy and, if not installed and used in accordance with the instructions, may cause harmful interference to radio communications. However, there is no guarantee that interference will not occur in a particular installation. If this equipment does cause harmful interference to radio or television reception, which can be determined by turning the equipment off and on, the user is encouraged to try to correct the interference by one or more of the following measures:

- Reorient or relocate the receiving antenna.
- Increase the separation between the equipment and receiver.
- Connect the equipment into an outlet on a circuit different from that to which the receiver is connected.
- Consult the dealer or an experienced radio or television technician for help.

Modifications

The FCC requires the user to be notified that any changes or modifications made to this device that are not expressly approved by Tanita Corporation may void the user's authority to operate the equipment.

Disposal



This equipment is electronic device. Please dispose of this equipment appropriately as not the general household waste but electronic equipment. Please follow a regional regulation when you dispose of this.

<U.S.A. representative>

TANITA Corporation of America, Inc.

2625 South Clearbrook Drive, Arlington Heights, Illinois 60005, U.S.A. TEL: 1-847-640-9241 FAX: 1-847-640-9261 <http://www.tanita.com>

<Manufacturer>

TANITA Corporation

1-14-2, Maeno-cho, Itabashi-ku, Tokyo 174-8630, Japan TEL: +81 (0) 3-3968-7048 FAX: +81 (0) 3-3967-3766 <http://www.tanita.co.jp>

TANITA Europe B.V.

Hoogoorddreef 56-E,
1101 BE Amsterdam, the Netherlands
TEL: +31-20-560-2970
FAX: +31-20-560-2988
<http://www.tanita.eu>

TANITA Health Equipment H.K.LTD.

Unit 301-303, Wing On Plaza, 3/F., 62 Mody Rord,
Tsimshatsui East, Kowloon, Hong Kong
TEL: +852-2834-3917
FAX: +852-2838-8667
www.tanita.asia

TANITA India Private Limited

A-502, Mittal Commericia, Off. M.V. Road(Andheri Kurla Road),
Marol, Andheri-East, Mumbai 400 059 INDIA
TEL: +91-22-3192-6107
FAX: +91-22-2859-9143
www.tanita.co.in

TANITA (Shanghai) Trading Co., Ltd.

Room 8005, 877 Huai Hai Zhong Lu, Shanghai,
The People's Republic of China
TEL: +86-21-6474-6803
FAX: +86-21-6474-7901
www.tanita.com.cn